

PREMIUM LIST



RED CANYONS KENNEL CLUB

Licensed by the American Kennel Club

FRIDAY, SEPTEMBER 6, 2024 AM SHOW 1

FRIDAY, SEPTEMBER 6, 2024 PM SHOW 2

SATURDAY, SEPTEMBER 7, 2024

SUNDAY, SEPTEMBER 8, 2024

INDOORS, UNBENCHED • SHOW HOURS: 6:00 am to 7:00 pm

New for 2024 - AKC Fetch Trials

WASHINGTON COUNTY REGIONAL LEGACY PARK FAIRGROUNDS

5500 West 700 South (Indoor Arena and Covered Arena)

Hurricane, UT 84737

ENTRIES CLOSE NOON WEDNESDAY, AUGUST 21, 2024 PDT

IMPORTANT NOTICE

Mail Entries with Fees to Jack Bradshaw
320 Maple Avenue, Torrance, CA 90503
Make checks payable to Jack Bradshaw

FAX: (323) 727-2949 E-MAIL ENTRIES: www.jbradshaw.com

For entries made online there will be a service fee of \$4.00 per dog per show.

There will be a \$4.00 service fee if entries are cancelled for any reason per dog per show.

These service fees are non-refundable.

Include MasterCard, Visa or American Express number & expiration date

There will be a \$4.00 convenience fee charged per dog per show when using a credit card for payment of hand delivered or mailed in entries. Fax machines are available 24 hours a day.

Hand Deliveries - 320 Maple Avenue, Torrance, CA 90503

All entries with fees must be in the office of the Superintendent not later than

NOON WEDNESDAY, AUGUST 21, 2024 PT

After which time no entries may be accepted, cancelled, changed, substituted, corrected, completed, or signed and no entry fees refunded. Any change or cancellation must be made in writing and received prior to closing, except as provided for in Chapter 11, Section 6 of the American Kennel Club Dog Show Rules. Fax entries that are received incomplete or unable to read will not be accepted. The proof of transmission is not proof for verifying faxed entries. PLEASE DO NOT WAIT UNTIL THE CLOSE OF ENTRY DAY TO FAX OR E-MAIL YOUR ENTRIES. IF YOU FAX OR E-MAIL ON A CLOSE OF ENTRY DAY, PLEASE SUBMIT PRIOR TO 9:00 AM.

ENTRY FEES

First entry of a dog at this show*	\$36.00
Each additional class for the same dog	32.00
(*includes AKC Event Services fee \$3.00, AKC recording fee \$.50)	

RAMP - At the discretion of the judge, the following breeds may be judged on a ramp through all levels of competition: Nova Scotia Duck Tolling Retriever, American Water Spaniel, Boykin Spaniels, English Springer Spaniel, Field Spaniel, Welsh Springer Spaniel, Grand Basset Griffon Vendeen, Whippet, German Pinscher, Standard Schnauzer, American Staffordshire Terrier, Irish Terrier, Soft Coated Wheaten Terrier, Staffordshire Bull Terrier, Finnish Spitz, Australian Cattle Dogs, Entlebucher Mountain Dog, Finnish Lapphund, Icelandic Sheepdog, Mudi, Norwegian Buhund, Polish Lowland Sheepdog, Puli, Spanish Water Dog, Norrbottenspet.

The following breeds may be judged on the ground, table or ramp: Miniature Bull Terrier.

The following breeds must be judged on a ramp through all levels of conformation competition: Lagotto Romagnolo, Clumber Spaniel, Sussex Spaniel, Basset Hound, Cirneco dell'Etna, Kerry Blue Terrier, Bulldog, Chinese Shar-Pei, Chow Chow, Keeshond.

Junior showmanship judges should follow the above.

Ramps may be used in emergency situations to judge any breed. (In all but emergency situations, the exhibitor has no recourse. In an emergency situation, where use of a ramp is not indicated in the premium list, an exhibitor has the option of withdrawing their entry and receiving a refund.) 4/3/24

RED CANYONS KENNEL CLUB

(Licensed by the American Kennel Club)

FRIDAY, SEPTEMBER 6, 2024 AM SHOW 1

*Limit of 600 entries includes conformation. No Junior Show offered. No NOHS offered.
No limit on Obedience or Rally trials.*

FRIDAY, SEPTEMBER 6, 2024 SECOND SHOW 2

Limit of 600 entries includes conformation, juniors. NOHS is offered. No trials offered

SATURDAY, SEPTEMBER 7, 2024

No Limit. Junior Show, Obedience, Rally are offered. NOHS is offered.

SUNDAY, SEPTEMBER 8, 2024

No Limit. Junior Show, Obedience, Rally are offered. NOHS is offered.

Rings 1-6 Indoor, 7-8 Harmony Bldg, Trials in Grafton Bldg

INDOORS, UNBENCHED • SHOW HOURS: 6:00 AM to 7:00 PM

WASHINGTON COUNTY REGIONAL LEGACY PARK FAIRGROUNDS

INDOOR ARENA AND COVERED ARENA

5500 West 700 South, Hurricane, UT 84737



CERTIFICATION

Permission has been granted by the American Kennel Club for the holding of this event under American Kennel Club rules and regulations. **Gina M. DiNardo, Executive Secretary**

OFFICIAL PHOTOGRAPHER

Bettina Bienefeld bestinshowphoto.com

Only the listed official photographer may take win pictures. A win picture is defined as consisting of a judge, dog and ribbons.

Superintendents

Jack Bradshaw Dog Show Superintendents/Est. 1898

320 Maple Avenue, Torrance, CA 90503

Telephone: (323) 727-0136; FAX: (323) 727-2949; WEB: www.jbradshaw.com

Marion Bradshaw / Barbara Bradshaw / Susan Bradshaw MacLyman

Julie Bradshaw Draper / John Bradshaw / Eloise O'Donnell / Keith MacLyman

One or more of the above superintendents will attend the show

A Message from Red Canyons Kennel Club

Hello everyone,

I am Dave Showalter, the President of RCKC. I have some exciting news for you. We are back to our original format using all of the buildings at the venue for our shows in 2024. We will have 8 conformation rings this year, with 6 in the Arena Building and 2 in the Harmony Building. Rally and Obedience will return to the Grafton Building.

We have added a new event this year, AKC Fetch! It will be held both Friday and Saturday in the Outdoor Covered Arena after Rally and Obedience is finished for the day. It has been our goal from the beginning to find a way to maximize our shows in a way that makes it a special weekend for all the exhibitors, judges, and visitors who come to Southern Utah. By the way, here is a spoiler alert for 2025. We will be adding Dock Diving events!!!

We have also recently launched an all-new Red Canyons Kennel Club website. In addition to a lot of new club-related information, there will be an improved reservation system for all RV and Grooming services.

Please check out: <https://www.redcanyonskc.org>

Our OFA testing services and microchipping will again be available in 2024. This year it will be in the air-conditioned comfort of the Grafton Building.

We will still have the same RV and Grooming reservations available this year. We have a limited number of both 50amp and 30amp spots, along with dry RV spaces. Please remember that if you want either your RV or Grooming spots with other people, please make your reservations on our club website as a group. Please see the reservation page here in the Premium for further detailed information.

Please reach out to me personally if I can either help you or direct you to the appropriate person for assistance.

My email is entradadave@msn.com and my phone number is 435-668-0969.

Thank you all for considering our shows and I look forward to seeing you in September.

Saturday Sept 7, 2024

Join us a half hour after Best in Show for our annual 9/11 tribute with refreshments by the Raffle Table

We encourage people to join the celebration and wear Red White Blue!

CLASSIFICATION

This classification applies to each breed, whose name is listed. Any change in regular or non-regular classes appears under the individual breed heading.

REGULAR CLASSES

Puppy Dogs 6 mos. and under 9 mos.	Puppy Bitches 6 mos. and under 9 mos.
Puppy Dogs 9 mos. and under 12 mos.	Puppy Bitches 9 mos. and under 12 mos.
12 mos. and under 18 mos. Dogs	12 mos. and under 18 mos. Bitches
Novice Dogs	Novice Bitches
Amateur Owner Handler Dogs	Amateur Owner Handler Bitches

Bred by Exhibitor Dogs, Puppy Bred by Exhibitor Dogs, Adult

Bred by Exhibitor Bitches, Puppy Bred by Exhibitor Bitches, Adult

American Bred Dogs	American Bred Bitches
Open Dogs	Open Bitches
Winners Dog	Winners Bitch

NON-REGULAR CLASSES, INVOLVING SINGLE DOG ENTRIES

Veteran (divided by sex)- 7 years of age and older

BEST OF BREED (VARIETY) COMPETITION

Best of Breed (Variety) Competition - "The following categories of dogs may be entered and shown in Best of Breed competition. Dogs that are Champions of Record. Dogs which according to their owner's records have completed the requirements for a championship but whose championships are unconfirmed. The entry and showing of dogs whose championships are unconfirmed is limited to a period of 90 days from the date of the show where a dog completed the requirements for a championship according to the owner's records. If, at the end of the 90-day period, the championship of a dog has not been confirmed by the American Kennel Club, no further entries of the dog for Best of Breed competition are to be made until its championship has been confirmed by the AKC."

JUNIOR SHOWMANSHIP CLASSIFICATION

Novice Junior	Novice Intermediate	Novice Senior
Open Junior	Open Intermediate	Open Senior Master

ALL-AMERICAN/MIXED BREEDS ARE ALLOWED IN THESE TRIALS
--

OBEDIENCE CLASSIFICATION

Novice A	Open A	Utility A
Novice B	Open B	Utility B

OBEDIENCE CLASSIFICATION – OPTIONAL TITLING CLASSES

Beginner Novice A	Beginner Novice B	
Graduate Novice	Graduate Open	Versatility
Preferred Novice	Preferred Open	Preferred Utility

RALLY CLASSIFICATION

Novice A, Novice B, Intermediate, Advanced A, Advanced B,
Excellent A, Excellent B, Master, Choice

Dogs will be judged in descending height order – include your jump height

JUDGES

Mr. Dana P. Cline	801 Branch Rd, Albany, GA 31705
Mr. Jon R. Cole	P.O. Box 160205, Nashville, TN 37216
Mrs. Karla Curtis	PO Box 5250, Pahrump, NV 89041
Ms. Sharon V. Derrick	60 Riverview Close SE, Calgary AB T2C 4C4, Canada
Ms. Carol Graham	292201 TWP Rd 262-A, Rocky View, AL T4A 0N2 Canada
Ms. Gloria Kerr	6820 E. Golden Ln, Sahuarita, AZ 85629
Mrs. Linn Klingel Brown	5053 E Cedar Creek DR, Cornville, AZ 86325
Ms. Susie Osburn	4048 Pepe Circle, Las Vegas, NV 89121
Mrs. Patricia V. Trotter	P.O. Box 222036, Carmel, CA 93922
Mr. John P. Wade	299 Steptoe Lane, Washoe Valley, NV 89704

*Judge was Provisional/Permit status for the assignment on the date the panel was approved by AKC.

Huge Thank You to the Amazing Sponsors This is list of General Trophy Fund sponsors

- Polly Pierce of K9 Sports Barn and Australian Shepherd fancier
- Dr Heather Johnson Cedar Veterinary Clinic
\$95 533 N Airport Rd, Cedar City, UT 84721 (435) 586-3400
- RANDY G. DELCORE, M.D Cedar Orthopedic Surgery Specialty Clinic
1335 Northfield Rd Ste 200, Cedar City
- Junior Handler Rowan Anderson
- Custom Concrete Concepts In loving memory of Precious and Mesha

FRIDAY # 1

BEST in SHOW

Ms. Sharon V. Derrick

SPORTING BREEDS

Mr. Jon R. Cole

Barbets	Mr. Cline
Bracchi Italiani	Mr. Cline
Brittany's	Mr. Cline
Lagotto Romagnolos	Mr. Cline
Nederlandse Kooikerhondjes	Mr. Cline
Pointer	Mr. Cline
Pointers (German Shorthaired)	Mr. Cline
Pointers (German Wirehaired)	Mr. Cline
Retrievers (Chesapeake Bay)	Mr. Cline
Retrievers (Curly-Coated)	Mr. Cline
Retrievers (Flat-Coated)	Mr. Cline
Retrievers (Golden)	Mr. Cline
Retrievers (Labrador)	Mr. Cline
Open, Black; Chocolate; Yellow. Same division of classes in bitches.	
Retrievers (NS Duck Tolling)	Mr. Cline
Setters (English)	Mr. Cline
Setters (Gordon)	Mr. Cline
Setters (Irish)	Mr. Cline
Setters (Irish, Red and White)	Mr. Cline
Spaniels (American Water)	Mr. Cline
Spaniels (Boykin)	Mr. Cline
Spaniels (Clumber)	Mr. Cline
Spaniels (Cocker) Black	Mr. Cline
Spaniels (Cocker) Ascob	Mr. Cline
Spaniels (Cocker) Parti Color	Mr. Cline
Spaniels (English Cocker)	Mr. Cline
Spaniels (English Springer)	Mr. Cline
Spaniels (Field)	Mr. Cline
Spaniels (Irish Water)	Mr. Cline
Spaniels (Sussex)	Mr. Cline
Spaniels (Welsh Springer)	Mr. Cline
Spinoni Italiani	Mr. Cline
Vizslas	Mr. Cline
Weimaraners	Mrs. Trotter
Wirehaired Pointing Griffons	Mr. Cline
Wirehaired Vizslas	Mrs. Trotter

HOUD BREEDS

Mrs. Linn Klingel Brown

Afghan Hounds	Ms. Kerr
American English Coonhounds	Ms. Kerr
American Foxhounds	Ms. Kerr
Azawakh	Ms. Kerr
Basenjis	Ms. Kerr
Basset Hounds	Ms. Kerr
Beagles (Thirteen Inch)	Ms. Kerr
Beagles (Fifteen Inch)	Ms. Kerr
Black and Tan Coonhounds	Ms. Kerr
Bloodhounds	Ms. Kerr
Bluetick Coonhounds	Ms. Kerr
Borzoi's	Ms. Kerr
Cirnechi dell Etna	Ms. Kerr
Dachshunds (Longhaired)	Ms. Kerr
Open, Miniature 11 lbs. and under at 12 mos. of age and older; Standard. Same division of classes in bitches.	
Dachshunds (Smooth)	Ms. Kerr
Open, Miniature 11 lbs. and under at 12 mos. of age and older; Standard. Same division of classes in bitches.	
Dachshunds (Wirehaired)	Ms. Kerr
Open, Miniature 11 lbs. and under at 12 mos. of age and older; Standard. Same division of classes in bitches.	
Foxhounds (English)	Ms. Kerr
Grand Basset Griffon Vendeens	Ms. Kerr
Greyhounds	Ms. Kerr
Harriers	Ms. Kerr
Ibizan Hounds	Ms. Kerr
Irish Wolfhounds	Ms. Kerr
Norwegian Elkhounds	Ms. Kerr
Otterhounds	Ms. Kerr

Petits Bassets Griffons Vendeens	Ms. Kerr
Pharaoh Hounds	Ms. Kerr
Plott Hounds	Ms. Kerr
Portuguese Podengo Pequenos	Ms. Kerr
Redbone Coonhound	Ms. Kerr
Rhodesian Ridgebacks	Mrs. Trotter
Salukis	Mrs. Trotter
Scottish Deerhounds	Ms. Kerr
Sloughi	Ms. Kerr
Treeing Walker Coonhounds	Ms. Kerr
Whippets	Ms. Kerr

WORKING BREEDS

Mrs. Patricia V. Trotter

Akitas	Mr. Cole
Alaskan Malamutes	Mr. Cole
Anatolian Shepherds	Mr. Cole
Bernese Mountain Dogs	Mr. Cole
Black Russian Terriers	Mr. Cole
Boerboel	Mr. Cole
Boxers	Mr. Cole
Open, Brindle; Fawn. Same division of classes in bitches.	
Bullmastiffs	Mr. Cole
Open, Brindle; Any Other Allowed Color. Same division of classes in bitches.	
Cane Corso	Ms. Derrick
Chinook	Mr. Cole
Doberman Pinschers	Mr. Cole
Open, Black; Any Other Allowed Color. Same division of classes in bitches.	
Dogos Argentino	Mr. Cole
Dogue De Bordeaux	Mr. Cole
German Pinschers	Mr. Cole
Giant Schnauzers	Mr. Cole
Great Danes	Mr. Cole
Open, Black; Blue; Brindle; Fawn; Harlequin; Mantle; Merle. Same division of classes in bitches.	
Great Pyrenees	Ms. Derrick
Greater Swiss Mountain Dogs	Ms. Graham
Komondorok	Mr. Cole
Kuvaszok	Mr. Cole
Leonberger	Ms. Graham
Mastiffs	Ms. Derrick
Neapolitan Mastiffs	Mr. Cole
Newfoundlands	Mr. Cole
Portuguese Water Dogs	Mr. Cole
Rottweilers	Mr. Cole
S T. Bernards	Ms. Graham
Samoyeds	Ms. Derrick
Siberian Huskies	Mr. Cole
Standard Schnauzers	Mrs. Klingel Brown
Tibetan Mastiffs	Mr. Cole

TERRIER BREEDS

Mr. John P. Wade

Airedale Terriers	Ms. Derrick
American Hairless Terriers	Ms. Derrick
American Staffordshire Terriers	Ms. Derrick
Australian Terriers	Ms. Derrick
Bedlington Terriers	Ms. Derrick
Border Terriers	Ms. Derrick
Bull Terriers (Colored)	Ms. Derrick
Bull Terriers (White)	Ms. Derrick
Cairn Terriers	Ms. Derrick
Cesky Terriers	Ms. Derrick
Dandie Dinmont Terriers	Ms. Derrick
Fox Terriers (Smooth)	Ms. Derrick
Fox Terriers (Wire)	Ms. Derrick
Glen of Imaal Terriers	Ms. Derrick
Irish Terriers	Ms. Derrick
Kerry Blue Terriers	Ms. Derrick
Lakeland Terriers	Ms. Derrick
Manchester Terriers (Standard)	Ms. Derrick
Miniature Bull Terriers	Ms. Derrick
Miniature Schnauzers	Ms. Derrick
Norfolk Terriers	Ms. Derrick
Norwich Terriers	Ms. Derrick
Parson Russell Terriers	Ms. Derrick
Rat Terriers	Ms. Derrick

FRIDAY # 1

Russell Terriers.....	Ms. Derrick
Scottish Terriers.....	Ms. Derrick
Sealyham Terriers.....	Ms. Derrick
Skye Terriers.....	Ms. Derrick
Soft Coated Wheaten Terriers.....	Ms. Derrick
Staffordshire Bull Terriers.....	Ms. Derrick
Welsh Terriers.....	Ms. Derrick
West Highland White Terriers.....	Ms. Derrick

TOY BREEDS

Ms. Gloria Kerr

Affenpinschers.....	Mr. Wade
Biewer Terrier.....	Mr. Wade
Brussels Griffons.....	Mr. Wade
Cavalier King Charles Spaniels.....	Mr. Wade
Open, Black & Tan; Blenheim; Ruby; Tri-Color.	
Same division of classes in bitches.	
Chihuahuas (Long Coat).....	Mr. Wade
Chihuahuas (Smooth Coat).....	Mr. Wade
Chinese Crested.....	Mr. Wade
Open, Hairless; Powderpuff. Same division of	
classes in bitches.	
English Toy Spaniel	
(Blenheim & Prince Charles).....	Mr. Wade
English Toy Spaniel	
(King Charles & Ruby).....	Mr. Wade
Havanese.....	Mrs. Trotter
Italian Greyhounds.....	Mr. Wade
Japanese Chin.....	Mr. Wade
Maltese.....	Mr. Wade
Manchester Terriers (Toy).....	Mr. Wade
Miniature Pinschers.....	Mr. Wade
Papillons.....	Mr. Wade
Pekingese.....	Mr. Wade
Pomeranian.....	Mr. Wade
Open, Red, Orange, Cream and Sable; Black,	
Brown and Blue; Any Other Allowed Color.	
Same division of classes in bitches.	
Poodle (Toy).....	Mr. Wade
Pugs.....	Mr. Wade
Open, Black; Fawn. Same division of classes in	
bitches.	
Russian Toy.....	Mr. Wade
Shih Tzu.....	Mr. Wade
Silky Terriers.....	Mr. Wade
Toy Fox Terriers.....	Mr. Wade
Yorkshire Terriers.....	Mr. Wade

NON-SPORTING BREEDS

Mrs. Linn Klingel Brown

American Eskimos.....	Mrs. Klingel Brown
Bichons Frises.....	Mrs. Klingel Brown
Boston Terriers.....	Mrs. Klingel Brown
Open, under 15 lbs.; 15 lbs and over Same	
division of classes in bitches.	
Bulldogs.....	Mrs. Klingel Brown
Chinese Shar-Pei.....	Mrs. Klingel Brown
Chow Chows.....	Mrs. Klingel Brown
Open, Black; Red; Any Other Allowed Color.	
Same division of classes in bitches.	
Coton de Tulear.....	Mrs. Klingel Brown
Dalmatians.....	Mrs. Klingel Brown
Open, Black Spotted; Liver-Spotted. Same divi-	
sion of classes in bitches.	
Finnish Spitz.....	Mrs. Klingel Brown
French Bulldogs.....	Mrs. Klingel Brown
Keeshonden.....	Mrs. Klingel Brown
Lhasa Apsos.....	Mrs. Klingel Brown
Lowchen.....	Mrs. Klingel Brown
Norwegian Lundehunds.....	Mrs. Klingel Brown
Poodles (Miniature).....	Mrs. Klingel Brown
Poodles (Standard).....	Mrs. Klingel Brown
Schipperkes.....	Mrs. Klingel Brown
Shiba-Inu.....	Mrs. Klingel Brown
Tibetan Spaniels.....	Mrs. Klingel Brown
Tibetan Terriers.....	Mrs. Klingel Brown
Xoloitzcuintli.....	Mrs. Klingel Brown

HERDING BREEDS

Mr. Dana P. Cline

Australian Cattle Dogs.....	Ms. Graham
Australian Shepherds.....	Ms. Graham
Open, Black; Blue Merle; Red Merle; Red.	
Same division of classes in bitches.	
Bearded Collies.....	Ms. Graham
Beauceron.....	Ms. Graham
Belgian Laekenois.....	Ms. Graham
Belgian Malinois.....	Ms. Graham
Belgian Sheepdogs.....	Ms. Graham
Belgian Tervuren.....	Ms. Graham
Bergamasco Sheepdogs.....	Ms. Graham
Berger Picard.....	Ms. Graham
Border Collies.....	Ms. Graham
Bouvier Des Flandres.....	Ms. Graham
Briards.....	Ms. Graham
Canaan Dog.....	Ms. Graham
Cardigan Welsh Corgis.....	Ms. Graham
Collies (Rough).....	Ms. Graham
Open, Blue; Sable & White; TriColor; White	
Same division of classes in bitches.	
Collies (Smooth).....	Ms. Graham
Entlebucher Mountain Dogs.....	Ms. Graham
Finnish Lapphund.....	Ms. Graham
German Shepherd Dogs.....	Ms. Graham
Icelandic Sheepdogs.....	Ms. Graham
Lancashire Heelers.....	Ms. Graham
Miniature American Shepherd.....	Ms. Graham
Open, Black; Blue Merle; Red Merle; Red.	
Same division of classes in bitches.	
Mudi.....	Mrs. Trotter
Norwegian Buhunds.....	Ms. Graham
Old English Sheepdogs.....	Ms. Graham
Pembroke Welsh Corgis.....	Mrs. Trotter
Polish Lowland Sheepdogs.....	Ms. Graham
Pulik.....	Ms. Graham
Pumik.....	Ms. Graham
Pyrenean Shepherds.....	Ms. Graham
Shetland Sheepdogs.....	Mrs. Trotter
Open, Sable and White; Any Other Allowed	
Color. Same division of classes in bitches.	
Spanish Water Dog.....	Ms. Graham
Swedish Vallhunds.....	Ms. Graham

MISCELLANEOUS CLASS

Mrs. Patricia V. Trotter

There will be a puppy, bred by and open class for dogs and bitches in each breed: Basset Fauve de Bretagne, Bolognese, Czechoslovakian Vlcak, Danish-Swedish Fardog, Dutch Shepherd, German Spitz, Japan Akitainu, Kai Ken, Norrbottenspets, Peruvian Inca Orchid, Portuguese Podengo, Pyrenean Mastiff, Russian Tsvet-anaya Bolonka, Small Munsterlander, Teddy Roosevelt Terrier, Yakutian Laika.

Jr. SHOWMANSHIP not offered Friday # 1

OBEDIENCE

Beginner Novice A.....	Mrs. Curtis
Beginner Novice B.....	Mrs. Curtis
Novice Class A.....	Mrs. Curtis
Novice Class B.....	Mrs. Curtis
Novice, Graduate.....	Mrs. Curtis
Novice, Preferred.....	Mrs. Curtis
Open Class A.....	Mrs. Curtis
Open Class B.....	Mrs. Curtis
Open, Graduate.....	Mrs. Curtis
Open, Preferred.....	Mrs. Curtis
Utility Class A.....	Mrs. Curtis
Utility Class B.....	Mrs. Curtis
Utility, Preferred.....	Mrs. Curtis
Versatility Class.....	Mrs. Curtis
Rally Novice A.....	Ms. Osburn
Rally Novice B.....	Ms. Osburn
Rally Intermediate.....	Ms. Osburn
Rally Advanced A.....	Ms. Osburn
Rally Advanced B.....	Ms. Osburn
Rally Excellent A.....	Ms. Osburn
Rally Excellent B.....	Ms. Osburn
Rally Master.....	Ms. Osburn
Rally Choice.....	Ms. Osburn

FRIDAY # 2

BEST in SHOW

Mr. Jon R. Cole

SPORTING BREEDS

Mrs. Patricia V. Trotter

Barbets	Ms. Kerr
Bracchi Italiani	Ms. Kerr
Brittanys	Ms. Kerr
Lagotto Romagnolos	Ms. Kerr
Nederlandse Kooikerhondjes	Ms. Kerr
Pointer	Ms. Kerr
Pointers (German Shorthaired)	Ms. Kerr
Pointers (German Wirehaired)	Ms. Kerr
Retrievers (Chesapeake Bay)	Ms. Kerr
Retrievers (Curly-Coated)	Ms. Kerr
Retrievers (Flat-Coated)	Ms. Kerr
Retrievers (Golden)	Ms. Kerr
Retrievers (Labrador)	Ms. Kerr
Open, Black; Chocolate; Yellow. Same division of classes in bitches.	
Retrievers (NS Duck Tolling)	Ms. Kerr
Setters (English)	Ms. Kerr
Setters (Gordon)	Ms. Kerr
Setters (Irish)	Ms. Kerr
Setters (Irish, Red and White)	Ms. Kerr
Spaniels (American Water)	Ms. Kerr
Spaniels (Boykin)	Ms. Kerr
Spaniels (Clumber)	Ms. Kerr
Spaniels (Cocker) Black	Ms. Kerr
Spaniels (Cocker) Ascob	Ms. Kerr
Spaniels (Cocker) Parti Color	Ms. Kerr
Spaniels (English Cocker)	Ms. Kerr
Spaniels (English Springer)	Ms. Kerr
Spaniels (Field)	Ms. Kerr
Spaniels (Irish Water)	Ms. Kerr
Spaniels (Sussex)	Ms. Kerr
Spaniels (Welsh Springer)	Ms. Kerr
Spinoni Italiani	Ms. Kerr
Vizslas	Ms. Kerr
Weimaraners	Mr. Cline
Wirehaired Pointing Griffons	Ms. Kerr
Wirehaired Vizslas	Mr. Cline

HOUD BREEDS

Ms. Carol Graham

Afghan Hounds	Ms. Graham
American English Coonhounds	Ms. Graham
American Foxhounds	Ms. Graham
Azawakh	Ms. Graham
Basenjis	Ms. Graham
Basset Hounds	Ms. Graham
Beagles (Thirteen Inch)	Ms. Graham
Beagles (Fifteen Inch)	Ms. Graham
Black and Tan Coonhounds	Ms. Graham
Bloodhounds	Ms. Graham
Bluetick Coonhounds	Ms. Graham
Borzoi	Ms. Graham
Cirnechi dell Etna	Ms. Graham
Dachshunds (Longhaired)	Ms. Graham
Open, Miniature 11 lbs. and under at 12 mos. of age and older; Standard. Same division of classes in bitches.	
Dachshunds (Smooth)	Ms. Graham
Open, Miniature 11 lbs. and under at 12 mos. of age and older; Standard. Same division of classes in bitches.	
Dachshunds (Wirehaired)	Ms. Graham
Open, Miniature 11 lbs. and under at 12 mos. of age and older; Standard. Same division of classes in bitches.	
Foxhounds (English)	Ms. Graham
Grand Basset Griffon Vendeens	Ms. Graham
Greyhounds	Ms. Graham

Harriers	Ms. Graham
Ibizan Hounds	Ms. Graham
Irish Wolfhounds	Ms. Graham
Norwegian Elkhounds	Ms. Graham
Otterhounds	Ms. Graham
Petits Bassets Griffons Vendeens	Ms. Graham
Pharaoh Hounds	Ms. Graham
Plott Hounds	Ms. Graham
Portuguese Podengo Pequenos	Ms. Graham
Redbone Coonhound	Ms. Graham
Rhodesian Ridgebacks	Mr. Cole
Salukis	Mr. Cole
Scottish Deerhounds	Ms. Graham
Sloughi	Ms. Graham
Treeing Walker Coonhounds	Ms. Graham
Whippets	Ms. Graham

WORKING BREEDS

Mr. John P. Wade

Akitas	Ms. Derrick
Alaskan Malamutes	Ms. Derrick
Anatolian Shepherds	Ms. Derrick
Bernese Mountain Dogs	Ms. Derrick
Black Russian Terriers	Ms. Derrick
Boerboel	Ms. Derrick
Boxers	Ms. Derrick
Open, Brindle; Fawn. Same division of classes in bitches.	
Bullmastiffs	Ms. Derrick
Open, Brindle; Any Other Allowed Color. Same division of classes in bitches.	
Cane Corso	Mr. Cole
Chinook	Ms. Derrick
Doberman Pinschers	Ms. Derrick
Open, Black; Any Other Allowed Color. Same division of classes in bitches.	
Dogos Argentino	Ms. Derrick
Dogue De Bordeaux	Ms. Derrick
German Pinschers	Ms. Derrick
Giant Schnauzers	Ms. Derrick
Great Danes	Ms. Derrick
Open, Black; Blue; Brindle; Fawn; Harlequin; Mantle; Merle. Same division of classes in bitches.	
Great Pyrenees	Mr. Cole
Greater Swiss Mountain Dogs	Mr. Cole
Komondorok	Ms. Derrick
Kuvaszok	Ms. Derrick
Leonberger	Mr. Cole
Mastiffs	Mr. Cole
Neapolitan Mastiffs	Ms. Derrick
Newfoundlands	Ms. Derrick
Portuguese Water Dogs	Ms. Derrick
Rottweilers	Ms. Derrick
S T. Bernards	Mr. Cole
Samoyeds	Mr. Cole
Siberian Huskies	Ms. Derrick
Standard Schnauzers	Mr. Cole
Tibetan Mastiffs	Ms. Derrick

TERRIER BREEDS

Ms. Gloria Kerr

Airedale Terriers	Mr. Cline
American Hairless Terriers	Mr. Cline
American Staffordshire Terriers	Mr. Cline
Australian Terriers	Mr. Cline
Bedlington Terriers	Mr. Cline
Border Terriers	Mr. Cline
Bull Terriers (Colored)	Mr. Cline
Bull Terriers (White)	Mr. Cline
Cairn Terriers	Mr. Cline
Cesky Terriers	Mr. Cline
Dandie Dinmont Terriers	Mr. Cline
Fox Terriers (Smooth)	Mr. Cline
Fox Terriers (Wire)	Mr. Cline

FRIDAY # 2

Glen of Imaal Terriers	Mr. Cline
Irish Terriers	Mr. Cline
Kerry Blue Terriers	Mr. Cline
Lakeland Terriers	Mr. Cline
Manchester Terriers (Standard)	Mr. Cline
Miniature Bull Terriers	Mr. Cline
Miniature Schnauzers	Mr. Cline
Norfolk Terriers	Mr. Cline
Norwich Terriers	Mr. Cline
Parson Russell Terriers	Mr. Cline
Rat Terriers	Mr. Cline
Russell Terriers	Mr. Cline
Scottish Terriers	Mr. Cline
Sealyham Terriers	Mr. Cline
Skye Terriers	Mr. Cline
Soft Coated Wheaten Terriers	Mr. Cline
Staffordshire Bull Terriers	Mr. Cline
Welsh Terriers	Mr. Cline
West Highland White Terriers	Mr. Cline

TOY BREEDS

Ms. Carol Graham

Affenpinschers	Mrs. Klingel Brown
Biewer Terrier	Mrs. Klingel Brown
Brussels Griffons	Mrs. Klingel Brown
Cavalier King Charles Spaniels	Mrs. Klingel Brown
Open, Black & Tan; Blenheim; Ruby; Tri-Color.	
Same division of classes in bitches.	
Chihuahuas (Long Coat)	Mrs. Klingel Brown
Chihuahuas (Smooth Coat)	Mrs. Klingel Brown
Chinese Crested	Mrs. Klingel Brown
Open, Hairless; Powderpuff. Same division of	
classes in bitches.	
English Toy Spaniel	
(Blenheim & Prince Charles)	Mrs. Klingel Brown
English Toy Spaniel	
(King Charles & Ruby)	Mrs. Klingel Brown
Havanese	Mr. Wade
Italian Greyhounds	Mrs. Klingel Brown
Japanese Chin	Mrs. Klingel Brown
Maltese	Mrs. Klingel Brown
Manchester Terriers (Toy)	Mrs. Klingel Brown
Miniature Pinschers	Mrs. Klingel Brown
Papillons	Mrs. Klingel Brown
Pekingese	Mrs. Klingel Brown
Pomeranian	Mrs. Klingel Brown
Open, Red, Orange, Cream and Sable; Black,	
Brown and Blue; Any Other Allowed Color.	
Same division of classes in bitches.	
Poodle (Toy)	Mrs. Klingel Brown
Pugs	Mrs. Klingel Brown
Open, Black; Fawn. Same division of classes in	
bitches.	
Russian Toy	Mrs. Klingel Brown
Shih Tzu	Mrs. Klingel Brown
Silky Terriers	Mrs. Klingel Brown
Toy Fox Terriers	Mrs. Klingel Brown
Yorkshire Terriers	Mrs. Klingel Brown

NON-SPORTING BREEDS

Mr. Dana P. Cline

American Eskimos	Mr. Wade
Bichons Frises	Mr. Wade
Boston Terriers	Mr. Wade
Open, under 15 lbs.; 15 lbs and over Same	
division of classes in bitches.	
Bulldogs	Mr. Wade
Chinese Shar-Pei	Mr. Wade
Chow Chows	Mr. Wade
Open, Black; Red; Any Other Allowed Color.	
Same division of classes in bitches.	
Coton de Tulear	Mr. Wade
Dalmatians	Mr. Wade
Open, Black Spotted; Liver-Spotted. Same divi-	

sion of classes in bitches.

Finnish Spitz	Mr. Wade
French Bulldogs	Mr. Wade
Keeshonden	Mr. Wade
Lhasa Apsos	Mr. Wade
Lowchen	Mr. Wade
Norwegian Lundehunds	Mr. Wade
Poodles (Miniature)	Mr. Wade
Poodles (Standard)	Mr. Wade
Schipperkes	Mr. Wade
Shiba-Inu	Mr. Wade
Tibetan Spaniels	Mr. Wade
Tibetan Terriers	Mr. Wade
Xoloitzcuintli	Mr. Wade

HERDING BREEDS

Mrs. Linn Klingel Brown

Australian Cattle Dogs	Mrs. Trotter
Australian Shepherds	Mrs. Trotter
Open, Black; Blue Merle; Red Merle; Red.	
Same division of classes in bitches.	
Bearded Collies	Mrs. Trotter
Beauceron	Mrs. Trotter
Belgian Laekenois	Mrs. Trotter
Belgian Malinois	Mrs. Trotter
Belgian Sheepdogs	Mrs. Trotter
Belgian Tervuren	Mrs. Trotter
Bergamasco Sheepdogs	Mrs. Trotter
Berger Picard	Mrs. Trotter
Border Collies	Mrs. Trotter
Bouvier Des Flandres	Mrs. Trotter
Briards	Mrs. Trotter
Canaan Dog	Mrs. Trotter
Cardigan Welsh Corgis	Mrs. Trotter
Collies (Rough)	Mrs. Trotter
Open, Blue; Sable & White; TriColor; White	
Same division of classes in bitches.	
Collies (Smooth)	Mrs. Trotter
Entlebucher Mountain Dogs	Mrs. Trotter
Finnish Lapphund	Mrs. Trotter
German Shepherd Dogs	Mrs. Trotter
Icelandic Sheepdogs	Mrs. Trotter
Lancashire Heelers	Mrs. Trotter
Miniature American Shepherd	Mrs. Trotter
Open, Black; Blue Merle; Red Merle; Red.	
Same division of classes in bitches.	
Mudi	Mr. Cline
Norwegian Buhunds	Mrs. Trotter
Old English Sheepdogs	Mrs. Trotter
Pembroke Welsh Corgis	Mr. Cline
Polish Lowland Sheepdogs	Mrs. Trotter
Pulik	Mrs. Trotter
Pumik	Mrs. Trotter
Pyrenean Shepherds	Mrs. Trotter
Shetland Sheepdogs	Mr. Cline
Open, Sable and White; Any Other Allowed	
Color. Same division of classes in bitches.	
Spanish Water Dog	Mrs. Trotter
Swedish Vallhunds	Mrs. Trotter

MISCELLANEOUS CLASS

Mr. Jon R. Cole

There will be a puppy, bred by and open class for dogs and bitches in each breed: Basset Fauve de Bretagne, Bolognese, Czechoslovakian Vlcak, Danish-Swedish Farmdog, Dutch Shepherd, German Spitz, Japan Akitainu, Kai Ken, Norrbottenspets, Peruvian Inca Orchid, Portuguese Podengo, Pyrenean Mastiff, Russian Tsvet-anaya Bolonka, Small Munsterlander, Teddy Roosevelt Terrier, Yakutian Laika.

JUNIOR SHOWMANSHIP COMPETITION

Mr. Jon R. Cole

TRIALS ARE NOT OFFERED FRIDAY # 2

SATURDAY

BEST in SHOW

Mrs. Patricia V. Trotter

SPORTING BREEDS

Mr. Dana P. Cline

Barbets	Mr. Cole
Bracchi Italiani	Mr. Cole
Brittanys	Mr. Cole
Lagotto Romagnolos	Mr. Cole
Nederlandse Kooikerhondjes	Mr. Cole
Pointer	Mr. Cole
Pointers (German Shorthaired)	Mr. Cole
Pointers (German Wirehaired)	Mr. Cole
Retrievers (Chesapeake Bay)	Mr. Cole
Retrievers (Curly-Coated)	Mr. Cole
Retrievers (Flat-Coated)	Mr. Cole
Retrievers (Golden)	Mr. Cole
Retrievers (Labrador)	Mr. Cole
Open, Black; Chocolate; Yellow. Same division of classes in bitches.	
Retrievers (NS Duck Tolling)	Mr. Cole
Setters (English)	Mr. Cole
Setters (Gordon)	Mr. Cole
Setters (Irish)	Mr. Cole
Setters (Irish, Red and White)	Mr. Cole
Spaniels (American Water)	Mr. Cole
Spaniels (Boykin)	Mr. Cole
Spaniels (Clumber)	Mr. Cole
Spaniels (Cocker) Black	Mr. Cole
Spaniels (Cocker) Ascob	Mr. Cole
Spaniels (Cocker) Parti Color	Mr. Cole
Spaniels (English Cocker)	Mr. Cole
Spaniels (English Springer)	Mr. Cole
Spaniels (Field)	Mr. Cole
Spaniels (Irish Water)	Mr. Cole
Spaniels (Sussex)	Mr. Cole
Spaniels (Welsh Springer)	Mr. Cole
Spinoni Italiani	Mr. Cole
Vizslas	Ms. Graham
Weimaraners	Ms. Graham
Wirehaired Pointing Griffons	Mr. Cole
Wirehaired Vizslas	Ms. Graham

HOUD BREEDS

Ms. Gloria Kerr

Afghan Hounds	Mrs. Klingel Brown
American English Coonhounds	Mrs. Klingel Brown
American Foxhounds	Mrs. Klingel Brown
Azawakh	Mrs. Klingel Brown
Basenjis	Mrs. Klingel Brown
Basset Hounds	Mrs. Klingel Brown
Beagles (Thirteen Inch)	Mrs. Klingel Brown
Beagles (Fifteen Inch)	Mrs. Klingel Brown
Black and Tan Coonhounds	Mrs. Klingel Brown
Bloodhounds	Mrs. Klingel Brown
Bluetick Coonhounds	Mrs. Klingel Brown
Borzoi	Mrs. Klingel Brown
Cirnechi dell Etna	Mrs. Klingel Brown
Dachshunds (Longhaired)	Mrs. Klingel Brown
Open, Miniature 11 lbs. and under at 12 mos. of age and older; Standard. Same division of classes in bitches.	
Dachshunds (Smooth)	Mrs. Klingel Brown
Open, Miniature 11 lbs. and under at 12 mos. of age and older; Standard. Same division of classes in bitches.	
Dachshunds (Wirehaired)	Mrs. Klingel Brown
Open, Miniature 11 lbs. and under at 12 mos. of age and older; Standard. Same division of classes in bitches.	
Foxhounds (English)	Mrs. Klingel Brown
Grand Basset Griffon Vendeens	Mrs. Klingel Brown
Greyhounds	Mrs. Klingel Brown
Harriers	Mrs. Klingel Brown
Ibizan Hounds	Mrs. Klingel Brown
Irish Wolfhounds	Mrs. Klingel Brown
Norwegian Elkhounds	Mrs. Klingel Brown
Otterhounds	Mrs. Klingel Brown
Petits Bassets Griffons Vend	Mrs. Klingel Brown

Pharaoh Hounds	Mrs. Klingel Brown
Plott Hounds	Mrs. Klingel Brown
Portuguese Podengo Pequenos	Mrs. Klingel Brown
Redbone Coonhound	Mrs. Klingel Brown
Rhodesian Ridgebacks	Ms. Graham
Salukis	Mrs. Klingel Brown
Scottish Deerhounds	Mrs. Klingel Brown
Sloughi	Mrs. Klingel Brown
Treeing Walker Coonhounds	Mrs. Klingel Brown
Whippets	Mrs. Klingel Brown

WORKING BREEDS

Ms. Sharon V. Derrick

Akitas	Mr. Cline
Alaskan Malamutes	Mr. Cline
Anatolian Shepherds	Mr. Cline
Bernese Mountain Dogs	Mr. Cline
Black Russian Terriers	Mr. Cline
Boerboel	Mr. Cline
Boxers	Mr. Cline
Open, Brindle; Fawn. Same division of classes in bitches.	
Bullmastiffs	Mr. Cline
Open, Brindle; Any Other Allowed Color. Same division of classes in bitches.	
Cane Corso	Mrs. Trotter
Chinook	Mr. Cline
Doberman Pinschers	Mr. Cline
Open, Black; Any Other Allowed Color. Same division of classes in bitches.	
Dogos Argentino	Mr. Cline
Dogue De Bordeaux	Mr. Cline
German Pinschers	Mr. Cline
Giant Schnauzers	Mr. Cline
Great Danes	Mr. Cline
Open, Black; Blue; Brindle; Fawn; Harlequin; Mantle; Merle. Same division of classes in bitches.	
Great Pyrenees	Mrs. Trotter
Greater Swiss Mountain Dogs	Mr. Wade
Komondorok	Mr. Cline
Kuvaszok	Mr. Cline
Leonberger	Mr. Wade
Mastiffs	Mrs. Trotter
Neapolitan Mastiffs	Mr. Cline
Newfoundlands	Mr. Cline
Portuguese Water Dogs	Mr. Cline
Rottweilers	Mr. Cline
S T. Bernards	Mr. Wade
Samoyeds	Mr. Cline
Siberian Huskies	Mr. Cline
Standard Schnauzers	Mr. Wade
Tibetan Mastiffs	Mr. Cline

TERRIER BREEDS

Ms. Carol Graham

Airedale Terriers	Mr. Wade
American Hairless Terriers	Mr. Wade
American Staffordshire Terriers	Mr. Wade
Australian Terriers	Mr. Wade
Bedlington Terriers	Mr. Wade
Border Terriers	Mr. Wade
Bull Terriers (Colored)	Mr. Wade
Bull Terriers (White)	Mr. Wade
Cairn Terriers	Mr. Wade
Cesky Terriers	Mr. Wade
Dandie Dinmont Terriers	Mr. Wade
Fox Terriers (Smooth)	Mr. Wade
Fox Terriers (Wire)	Mr. Wade
Glen of Imaal Terriers	Mr. Wade
Irish Terriers	Mr. Wade
Kerry Blue Terriers	Mr. Wade
Lakeland Terriers	Mr. Wade
Manchester Terriers (Standard)	Mr. Wade
Miniature Bull Terriers	Mr. Wade
Miniature Schnauzers	Mr. Wade
Norfolk Terriers	Mr. Wade
Norwich Terriers	Mr. Wade
Parson Russell Terriers	Mr. Wade
Rat Terriers	Mr. Wade
Russell Terriers	Mr. Wade
Scottish Terriers	Mr. Wade

SATURDAY

Sealyham Terriers.....	Mr. Wade
Skye Terriers.....	Mr. Wade
Soft Coated Wheaten Terriers.....	Mr. Wade
Staffordshire Bull Terriers.....	Mr. Wade
Welsh Terriers.....	Mr. Wade
West Highland White Terriers.....	Mr. Wade

TOY BREEDS

Mr. John P. Wade

Affenpinschers.....	Ms. Derrick
Biewer Terrier.....	Ms. Derrick
Brussels Griffons.....	Ms. Derrick
Cavalier King Charles Spaniels.....	Ms. Derrick
Open, Black & Tan; Blenheim; Ruby; Tri-Color. Same division of classes in bitches.	
Chihuahuas (Long Coat).....	Ms. Derrick
Chihuahuas (Smooth Coat).....	Ms. Derrick
Chinese Crested.....	Ms. Derrick
Open, Hairless; Powderpuff. Same division of classes in bitches.	
English Toy Spaniel (Blenheim & Prince Charles).....	Ms. Derrick
English Toy Spaniel (King Charles & Ruby).....	Ms. Derrick
Havanese.....	Mrs. Klingel Brown
Italian Greyhounds.....	Ms. Derrick
Japanese Chin.....	Ms. Derrick
Maltese.....	Ms. Derrick
Manchester Terriers (Toy).....	Ms. Derrick
Miniature Pinschers.....	Ms. Derrick
Papillons.....	Ms. Derrick
Pekingese.....	Ms. Derrick
Pomeranian.....	Ms. Derrick
Open, Red, Orange, Cream and Sable; Black, Brown and Blue; Any Other Allowed Color. Same division of classes in bitches.	
Poodle (Toy).....	Ms. Derrick
Pugs.....	Ms. Derrick
Open, Black; Fawn. Same division of classes in bitches.	
Russian Toy.....	Ms. Derrick
Shih Tzu.....	Ms. Derrick
Silky Terriers.....	Ms. Derrick
Toy Fox Terriers.....	Ms. Derrick
Yorkshire Terriers.....	Ms. Derrick

NON-SPORTING BREEDS

Ms. Carol Graham

American Eskimos.....	Mrs. Trotter
Bichons Frises.....	Mrs. Trotter
Boston Terriers.....	Mrs. Trotter
Open, under 15 lbs.; 15 lbs and over Same division of classes in bitches.	
Bulldogs.....	Mrs. Trotter
Chinese Shar-Pei.....	Mrs. Trotter
Chow Chows.....	Mrs. Trotter
Open, Black; Red; Any Other Allowed Color. Same division of classes in bitches.	
Coton de Tulear.....	Mrs. Trotter
Dalmatians.....	Mrs. Trotter
Open, Black Spotted; Liver-Spotted. Same divi- sion of classes in bitches.	
Finnish Spitz.....	Mrs. Trotter
French Bulldogs.....	Mrs. Trotter
Keeshonden.....	Mrs. Trotter
Lhasa Apsos.....	Mrs. Trotter
Lowchen.....	Mrs. Trotter
Norwegian Lundehunds.....	Mrs. Trotter
Poodles (Miniature).....	Mrs. Trotter
Poodles (Standard).....	Mrs. Trotter
Schipperkes.....	Mrs. Trotter
Shiba-Inu.....	Mrs. Trotter
Tibetan Spaniels.....	Mrs. Trotter
Tibetan Terriers.....	Mrs. Trotter
Xoloitzcuintli.....	Mrs. Trotter

HERDING BREEDS

Ms. Carol Graham

Australian Cattle Dogs.....	Ms. Kerr
-----------------------------	----------

Australian Shepherds.....	Ms. Kerr
Open, Black; Blue Merle; Red Merle; Red. Same division of classes in bitches.	
Bearded Collies.....	Ms. Kerr
Beauceron.....	Ms. Kerr
Belgian Laekenois.....	Ms. Kerr
Belgian Malinois.....	Ms. Kerr
Belgian Sheepdogs.....	Ms. Kerr
Belgian Tervuren.....	Ms. Kerr
Bergamasco Sheepdogs.....	Ms. Kerr
Berger Picard.....	Ms. Kerr
Border Collies.....	Ms. Kerr
Bouvier Des Flandres.....	Ms. Kerr
Briards.....	Ms. Kerr
Canaan Dog.....	Ms. Kerr
Cardigan Welsh Corgis.....	Ms. Kerr
Collies (Rough).....	Ms. Kerr
Open, Blue; Sable & White; TriColor; White Same division of classes in bitches.	
Collies (Smooth).....	Ms. Kerr
Entlebucher Mountain Dogs.....	Ms. Kerr
Finnish Lapphund.....	Ms. Kerr
German Shepherd Dogs.....	Ms. Kerr
Icelandic Sheepdogs.....	Ms. Kerr
Lancashire Heelers.....	Ms. Kerr
Miniature American Shepherd.....	Ms. Kerr
Open, Black; Blue Merle; Red Merle; Red. Same division of classes in bitches.	
Mudi.....	Ms. Graham
Norwegian Buhunds.....	Ms. Kerr
Old English Sheepdogs.....	Ms. Kerr
Pembroke Welsh Corgis.....	Ms. Graham
Polish Lowland Sheepdogs.....	Ms. Kerr
Pulik.....	Ms. Kerr
Pumik.....	Ms. Kerr
Pyrenean Shepherds.....	Ms. Kerr
Shetland Sheepdogs.....	Ms. Kerr
Open, Sable and White; Any Other Allowed Color. Same division of classes in bitches.	
Spanish Water Dog.....	Ms. Kerr
Swedish Vallhunds.....	Ms. Kerr

MISCELLANEOUS CLASS

Ms. Carol Graham

There will be a puppy, bred by and open class for dogs and bitches in each breed: Basset Fauve de Bretagne, Bolognese, Czechoslovakian Viciak, Danish-Swedish Farmdog, Dutch Shepherd, German Spitz, Japan Akitainu, Kai Ken, Norrbottenspets, Peruvian Inca Orchid, Portuguese Podengo, Pyrenean Mastiff, Russian Tsvetanaya Bolonka, Small Munsterlander, Teddy Roosevelt Terrier, Yakutian Laika.

JUNIOR SHOWMANSHIP COMPETITION

Mrs. Patricia V. Trotter

OBEDIENCE

Beginner Novice A.....	Ms. Osburn
Beginner Novice B.....	Ms. Osburn
Novice Class A.....	Ms. Osburn
Novice Class B.....	Ms. Osburn
Novice, Graduate.....	Ms. Osburn
Novice, Preferred.....	Ms. Osburn
Open Class A.....	Ms. Osburn
Open Class B.....	Ms. Osburn
Open, Graduate.....	Ms. Osburn
Open, Preferred.....	Ms. Osburn
Utility Class A.....	Ms. Osburn
Utility Class B.....	Ms. Osburn
Utility, Preferred.....	Ms. Osburn
Versatility Class.....	Ms. Osburn
Rally Novice A.....	Mrs. Curtis
Rally Novice B.....	Mrs. Curtis
Rally Intermediate.....	Mrs. Curtis
Rally Advanced A.....	Mrs. Curtis
Rally Advanced B.....	Mrs. Curtis
Rally Excellent A.....	Mrs. Curtis
Rally Excellent B.....	Mrs. Curtis
Rally Master.....	Mrs. Curtis
Rally Choice.....	Mrs. Curtis

SUNDAY

BEST in SHOW

Mr. Dana P. Cline

SPORTING BREEDS

Ms. Gloria Kerr

Barbets	Ms. Derrick
Bracchi Italiani	Ms. Derrick
Brittanys	Ms. Derrick
Lagotto Romagnolos	Ms. Derrick
Nederlandse Kooikerhondjes	Ms. Derrick
Pointer	Ms. Derrick
Pointers (German Shorthaired)	Ms. Derrick
Pointers (German Wirehaired)	Ms. Derrick
Retrievers (Chesapeake Bay)	Ms. Derrick
Retrievers (Curly-Coated)	Ms. Derrick
Retrievers (Flat-Coated)	Ms. Derrick
Retrievers (Golden)	Ms. Derrick
Retrievers (Labrador)	Ms. Derrick
Open, Black; Chocolate; Yellow. Same division of classes in bitches.	
Retrievers (NS Duck Tolling)	Ms. Derrick
Setters (English)	Ms. Derrick
Setters (Gordon)	Ms. Derrick
Setters (Irish)	Ms. Derrick
Setters (Irish, Red and White)	Ms. Derrick
Spaniels (American Water)	Ms. Derrick
Spaniels (Boykin)	Ms. Derrick
Spaniels (Clumber)	Ms. Derrick
Spaniels (Cocker) Black	Ms. Derrick
Spaniels (Cocker) Ascob	Ms. Derrick
Spaniels (Cocker) Parti Color	Ms. Derrick
Spaniels (English Cocker)	Ms. Derrick
Spaniels (English Springer)	Ms. Derrick
Spaniels (Field)	Ms. Derrick
Spaniels (Irish Water)	Ms. Derrick
Spaniels (Sussex)	Ms. Derrick
Spaniels (Welsh Springer)	Ms. Derrick
Spinoni Italiani	Ms. Derrick
Vizslas	Ms. Derrick
Weimaraners	Ms. Kerr
Wirehaired Pointing Griffons	Ms. Derrick
Wirehaired Vizslas	Ms. Kerr

HOUD BREEDS

Mrs. Patricia V. Trotter

Afghan Hounds	Mr. Wade
American English Coonhounds	Mr. Wade
American Foxhounds	Mr. Wade
Azawakh	Mr. Wade
Basenjis	Mr. Wade
Basset Hounds	Mr. Wade
Beagles (Thirteen Inch)	Mr. Wade
Beagles (Fifteen Inch)	Mr. Wade
Black and Tan Coonhounds	Mr. Wade
Bloodhounds	Mr. Wade
Bluetick Coonhounds	Mr. Wade
Borzoi	Mr. Wade
Cirnechi dell Etna	Mr. Wade
Dachshunds (Longhaired)	Mr. Wade
Open, Miniature 11 lbs. and under at 12 mos. of age and older; Standard. Same division of classes in bitches.	
Dachshunds (Smooth)	Mr. Wade
Open, Miniature 11 lbs. and under at 12 mos. of age and older; Standard. Same division of classes in bitches.	
Dachshunds (Wirehaired)	Mr. Wade
Open, Miniature 11 lbs. and under at 12 mos. of age and older; Standard. Same division of classes in bitches.	
Foxhounds (English)	Mr. Wade
Grand Basset Griffon Vendeens	Mr. Wade
Greyhounds	Mr. Wade
Harriers	Mr. Wade
Ibizan Hounds	Mr. Wade
Irish Wolfhounds	Mr. Wade
Norwegian Elkhounds	Mr. Wade
Otterhounds	Mr. Wade
Petits Bassets Griffons Vendeens	Mr. Wade

Pharaoh Hounds	Mr. Wade
Plott Hounds	Mr. Wade
Portuguese Podengo Pequenos	Mr. Wade
Redbone Coonhound	Mr. Wade
Rhodesian Ridgebacks	Mr. Wade
Salukis	Ms. Kerr
Scottish Deerhounds	Mr. Wade
Sloughi	Mr. Wade
Treeing Walker Coonhounds	Mr. Wade
Whippets	Mr. Wade

WORKING BREEDS

Ms. Carol Graham

Akitas	Mrs. Trotter
Alaskan Malamutes	Mrs. Trotter
Anatolian Shepherds	Mrs. Trotter
Bernese Mountain Dogs	Mrs. Trotter
Black Russian Terriers	Mrs. Trotter
Boerboel	Mrs. Trotter
Boxers	Mrs. Trotter
Open, Brindle; Fawn. Same division of classes in bitches.	
Bullmastiffs	Mrs. Trotter
Open, Brindle; Any Other Allowed Color. Same division of classes in bitches.	
Cane Corso	Mr. Cline
Chinook	Mrs. Trotter
Doberman Pinschers	Mrs. Trotter
Open, Black; Any Other Allowed Color. Same division of classes in bitches.	
Dogos Argentino	Mrs. Trotter
Dogue De Bordeaux	Mrs. Trotter
German Pinschers	Mrs. Trotter
Giant Schnauzers	Mrs. Trotter
Great Danes	Mrs. Trotter
Open, Black; Blue; Brindle; Fawn; Harlequin; Mantle; Merle. Same division of classes in bitches.	
Great Pyrenees	Mr. Cline
Greater Swiss Mountain Dogs	Mrs. Trotter
Komondorok	Mrs. Trotter
Kuvaszok	Mrs. Trotter
Leonberger	Mrs. Trotter
Mastiffs	Mr. Cline
Neapolitan Mastiffs	Mrs. Trotter
Newfoundlands	Mrs. Trotter
Portuguese Water Dogs	Mrs. Trotter
Rottweilers	Mrs. Trotter
S T. Bernards	Mrs. Trotter
Samoyeds	Mrs. Trotter
Siberian Huskies	Mrs. Trotter
Standard Schnauzers	Mrs. Trotter
Tibetan Mastiffs	Mrs. Trotter

TERRIER BREEDS

Mr. Jon R. Cole

Airedale Terriers	Ms. Kerr
American Hairless Terriers	Ms. Kerr
American Staffordshire Terriers	Ms. Kerr
Australian Terriers	Ms. Kerr
Bedlington Terriers	Ms. Kerr
Border Terriers	Ms. Kerr
Bull Terriers (Colored)	Ms. Kerr
Bull Terriers (White)	Ms. Kerr
Cairn Terriers	Ms. Kerr
Cesky Terriers	Ms. Kerr
Dandie Dinmont Terriers	Ms. Kerr
Fox Terriers (Smooth)	Ms. Kerr
Fox Terriers (Wire)	Ms. Kerr
Glen of Imaal Terriers	Ms. Kerr
Irish Terriers	Ms. Kerr
Kerry Blue Terriers	Ms. Kerr
Lakeland Terriers	Ms. Kerr
Manchester Terriers (Standard)	Ms. Kerr
Miniature Bull Terriers	Ms. Kerr
Miniature Schnauzers	Ms. Kerr
Norfolk Terriers	Ms. Kerr
Norwich Terriers	Ms. Kerr
Parson Russell Terriers	Ms. Kerr
Rat Terriers	Ms. Kerr
Russell Terriers	Ms. Kerr
Scottish Terriers	Ms. Kerr

SUNDAY

Sealyham Terriers.....	Ms. Kerr
Skye Terriers.....	Ms. Kerr
Soft Coated Wheaten Terriers	Ms. Kerr
Staffordshire Bull Terriers	Ms. Kerr
Welsh Terriers.....	Ms. Kerr
West Highland White Terriers	Ms. Kerr

TOY BREEDS

Mr. Jon R. Cole

Affenpinschers.....	Ms. Graham
Biewer Terrier.....	Ms. Graham
Brussels Griffons.....	Ms. Graham
Cavalier King Charles Spaniels.....	Ms. Graham
Open, Black & Tan; Blenheim; Ruby; Tri-Color. Same division of classes in bitches.	
Chihuahuas (Long Coat).....	Ms. Graham
Chihuahuas (Smooth Coat).....	Ms. Graham
Chinese Crested.....	Ms. Graham
Open, Hairless; Powderpuff. Same division of classes in bitches.	
English Toy Spaniel (Blenheim & Prince Charles).....	Ms. Graham
English Toy Spaniel (King Charles & Ruby).....	Ms. Graham
Havanese.....	Ms. Graham
Italian Greyhounds.....	Ms. Graham
Japanese Chin.....	Ms. Graham
Maltese.....	Ms. Graham
Manchester Terriers (Toy).....	Ms. Graham
Miniature Pinschers.....	Ms. Graham
Papillons.....	Ms. Graham
Pekingese.....	Ms. Graham
Pomeranian.....	Ms. Graham
Open, Red, Orange, Cream and Sable; Black, Brown and Blue; Any Other Allowed Color. Same division of classes in bitches.	
Poodle (Toy).....	Ms. Graham
Pugs.....	Ms. Graham
Open, Black; Fawn. Same division of classes in bitches.	
Russian Toy.....	Ms. Graham
Shih Tzu.....	Ms. Graham
Silky Terriers.....	Ms. Graham
Toy Fox Terriers.....	Ms. Graham
Yorkshire Terriers.....	Ms. Graham

NON-SPORTING BREEDS

Ms. Gloria Kerr

American Eskimos.....	Mr. Cline
Bichons Frises.....	Mr. Cline
Boston Terriers.....	Mr. Cline
Open, under 15 lbs.; 15 lbs and over Same division of classes in bitches.	
Bulldogs.....	Mr. Cline
Chinese Shar-Pei.....	Mr. Cline
Chow Chows.....	Mr. Cline
Open, Black; Red; Any Other Allowed Color. Same division of classes in bitches.	
Coton de Tulear.....	Mr. Cline
Dalmatians.....	Mr. Cline
Open, Black Spotted; Liver-Spotted. Same divi- sion of classes in bitches.	
Finnish Spitz.....	Mr. Cline
French Bulldogs.....	Mr. Cline
Keeshonden.....	Mr. Cline
Lhasa Apsos.....	Mr. Cline
Lowchen.....	Mr. Cline
Norwegian Lundehunds.....	Mr. Cline
Poodles (Miniature).....	Mr. Cline
Poodles (Standard).....	Mr. Cline
Schipperkes.....	Mr. Cline
Shiba-Inu.....	Mr. Cline
Tibetan Spaniels.....	Mr. Cline
Tibetan Terriers.....	Mr. Cline
Xoloitzcuintli.....	Mr. Cline

HERDING BREEDS

Mr. John P. Wade

Australian Cattle Dogs.....	Mr. Cole
-----------------------------	----------

Australian Shepherds.....	Mr. Cole
Open, Black; Blue Merle; Red Merle; Red. Same division of classes in bitches.	
Bearded Collies.....	Mr. Cole
Beauceron.....	Mr. Cole
Belgian Laekenois.....	Mr. Cole
Belgian Malinois.....	Mr. Cole
Belgian Sheepdogs.....	Mr. Cole
Belgian Tervuren.....	Mr. Cole
Bergamasco Sheepdogs.....	Mr. Cole
Berger Picard.....	Mr. Cole
Border Collies.....	Mr. Cole
Bouvier Des Flandres.....	Mr. Cole
Briards.....	Mr. Cole
Canaan Dog.....	Mr. Cole
Cardigan Welsh Corgis.....	Mr. Cole
Collies (Rough).....	Mr. Cole
Open, Blue; Sable & White; TriColor; White Same division of classes in bitches.	
Collies (Smooth).....	Mr. Cole
Entlebucher Mountain Dogs.....	Mr. Cole
Finnish Lapphund.....	Mr. Cole
German Shepherd Dogs.....	Mr. Cole
Icelandic Sheepdogs.....	Mr. Cole
Lancashire Heelers.....	Mr. Cole
Miniature American Shepherd.....	Mr. Cole
Open, Black; Blue Merle; Red Merle; Red. Same division of classes in bitches.	
Mudi.....	Mr. Cole
Norwegian Buhunds.....	Mr. Cole
Old English Sheepdogs.....	Mr. Cole
Pembroke Welsh Corgis.....	Mr. Cole
Polish Lowland Sheepdogs.....	Mr. Cole
Pulik.....	Mr. Cole
Pumik.....	Mr. Cole
Pyrenean Shepherds.....	Mr. Cole
Shetland Sheepdogs.....	Mr. Cole
Open, Sable and White; Any Other Allowed Color. Same division of classes in bitches.	
Spanish Water Dog.....	Mr. Cole
Swedish Vallhunds.....	Mr. Cole

MISCELLANEOUS CLASS

Ms. Gloria Kerr

There will be a puppy, bred by and open class for dogs and bitches in each breed: Basset Fauve de Bretagne, Bolognese, Czechoslovakian Vciak, Danish-Swedish Farmdog, Dutch Shepherd, German Spitz, Japan Akitainu, Kai Ken, Norrbottenspets, Peruvian Inca Orchid, Portuguese Podengo, Pyrenean Mastiff, Russian Tsvetanaya Bolonka, Small Munsterlander, Teddy Roosevelt Terrier, Yakutian Laika.

JUNIOR SHOWMANSHIP COMPETITION

Ms. Gloria Kerr

OBEDIENCE

Beginner Novice A.....	Mrs. Curtis
Beginner Novice B.....	Mrs. Curtis
Novice Class A.....	Mrs. Curtis
Novice Class B.....	Mrs. Curtis
Novice, Graduate.....	Mrs. Curtis
Novice, Preferred.....	Mrs. Curtis
Open Class A.....	Mrs. Curtis
Open Class B.....	Mrs. Curtis
Open, Graduate.....	Mrs. Curtis
Open, Preferred.....	Mrs. Curtis
Utility Class A.....	Mrs. Curtis
Utility Class B.....	Mrs. Curtis
Utility, Preferred.....	Mrs. Curtis
Versatility Class.....	Mrs. Curtis
Rally Novice A.....	Ms. Osburn
Rally Novice B.....	Ms. Osburn
Rally Intermediate.....	Ms. Osburn
Rally Advanced A.....	Ms. Osburn
Rally Advanced B.....	Ms. Osburn
Rally Excellent A.....	Ms. Osburn
Rally Excellent B.....	Ms. Osburn
Rally Master.....	Ms. Osburn
Rally Choice.....	Ms. Osburn

AM SHOW 1 FRIDAY SEPT 6 2024

The prizes are a custom-made money rosette that is created using the amount of cash on them listed under each prize, except for best junior handler in show that trophy will be a gift card from Chewy. All trophies must be picked up on the day of the event

BEST IN SHOW \$100 sponsored by Dave Showalter Sharcon Great Danes

OWNER HANDLER BEST IN SHOW \$75 sponsored by Dr Heather Johnson Cedar Veterinary Clinic

RESERVE BEST IN SHOW \$50 sponsored by Allegría Italian Greyhounds Nate & Erica Muno

RESERVE BEST IN SHOW OWNER HANDLER \$50 sponsored by Rafter V Farrier Supply PO Box 434 Parowan, UT, 84761

SPORTING GROUP sponsored by Lorene Chidester of CHIC English Springer Spaniels

OWNER HANDLER SPORTING GROUP \$40 sponsor by Lorene Chidester of CHIC English Springer Spaniels

HOUND GROUP \$ 40 sponsored by Kathy Vasquez in memory of her Mom Penny Weston and Freedom Rhodesian Ridgebacks

OWNER HANDLER HOUND GROUP \$40 sponsor by Grand River Dachshunds - Denise & Dana Gehring

WORKING GROUP \$40 in loving in memory of my brother Eric Palmer 10/31/67 to 1/29/2024 sponsored by Kristi Martin Ruffwyr Dachshunds

OWNER HANDLER WORKING GROUP \$40 In loving memory of Mercedes sponsored by Sherry Larsen Unleashed Pet Resort 3738 South River Road #1, Saint George, Ut

TERRIER GROUP \$40 sponsored by Rebecca White of WhiteOaks Cairn Terriers

OWNER HANDLER TERRIER GROUP \$40 Sponsored by Jennifer Sala

TOY GROUP \$40 In loving memory of in memory of Bruce Lehman Sponsored by Judy Lehman ASGARD'S Toy Fox Terriers Miniature American Shepherd

OWNER HANDLER TOY GROUP \$40 In loving memory of Precious and Mesha Sponsored by Custom Concrete Concepts

NON-SPORTING GROUP \$40 Sponsored by Laurie Mueller in loving remember of Jim Mueller

OWNER HANDLER NON SPORTING GROUP \$40 sponsored by Karen Green Desert Reef Standard Poodles

HERDING GROUP \$40 Sponsored by Risa Baumrind Canaan dog fancier.

OWNER HANDLER HERDING GROUP \$40 Sponsored by Leona Fischer, Forestwood Great Pyrenees

Best in Misc Class \$40 Sponsored by Kathryn Martel Sunnystone Peruvian Hairless Dogs

Best Junior Handler in Show In honor of Enoch Wildlife Rescue Center., sponsored by Tyner's Grooming 491 S Main St Cedar City, UT

OBEDIENCE HIGH SCORE IN SHOW \$40 Sponsored by Nancy Bentley

OBEDIENCE HIGH COMBINE SCORE IN OPEN B AND UTILITY \$45 Sponsored by Crissy Crismon & Jane Brennan in memory of 18-Sam-50 Okeenans Utah Escape CD RE CGC

RALLY HIGH COMBINE ADVANCE B & EXCELLENT B \$45 sponsored by Polly Pierce in memory of the great Willow

RALLY TRIPLE SCORE IN ADVANCE B, EXCELLENT B AND MASTER CLASSES \$50 sponsored by Crissy Crismon & Jane Brennan in memory of 18-Sam-50 Okeenans Utah Escape CD RE CGC

PM SHOW 2 FRIDAY SEPT 6 2024

The prizes are a custom-made money rosette that is created using the amount of cash on them listed under each prize, except for best junior handler in show that trophy will be a gift card from Chewy. All trophies must be picked up on the day of the event

BEST IN SHOW \$100 sponsored by Dave Showalter Sharcon Great Danes

OWNER HANDLER BEST IN SHOW \$75 sponsored by RANDY G. DELCORE, M.D Cedar Orthopedic

RESERVE BEST IN SHOW \$50 sponsored by Allegria Italian Greyhounds

Nate & Erica Muno

RESERVE BEST IN SHOW OWNER HANDLER \$50 sponsored by Castle Creek Mastiffs

SPORTING GROUP sponsored by Lorene Chidester of CHIC English Springer Spaniels

OWNER HANDLER SPORTING GROUP \$40 sponsored by Dr Heather Johnson Cedar Veterinary Clinic

HOUND GROUP \$ 40 sponsored by Suzi Haner Smith Sundog Saloon Salukis

OWNER HANDLER HOUND GROUP \$40 sponsor by Kristi Martin Ruffwyr Dachshunds in loving memory of pretty Prissy know officially as GrB Ruffwyr's Orange Blossom Special SW 11/13/08 -5/15/24

WORKING GROUP \$40 sponsored by Gail's Workman's Dog Obedience Training Made Easy

OWNER HANDLER WORKING GROUP \$40 In loving memory of Mercedes sponsored by Sherry Larsen Unleashed Pet Resort 3738 S River Rd, St George, UT, ,

TERRIERS GROUP \$40 sponsored by Rebecca White of WhiteOaks Cairn Terriers

OWNER HANDLER TERRIER GROUP \$40 In loving memory of Precious and Mesha sponsored by Custom Concrete Concepts.

TOY GROUP \$40 Sponsored by Sponsored by Asans Desert Japanese Chin

Anita Sanders & Carol Suvoski

OWNER HANDLER TOY GROUP \$40 Sponsored by In loving memory of Precious and Mesha sponsored by Custom Concrete Concepts

NON-SPORTING GROUP \$40 Sponsored by Laurie Mueller in loving remember of Jim Mueller

OWNER HANDLER NON SPORTING GROUP \$40 sponsored by Karen Green Desert Reef Standard Poodles

HERDING GROUP \$40 _In loving memory of Precious and Mesha sponsored by Custom Concrete Concepts

OWNER HANDLER HERDING GROUP \$40 Sponsored by Risa Baumrind Canaan dog fancier

Best in Misc Class \$40 Sponsored by Kathryn Martel Sunnystone Peruvian Hairless Dogs

SATURDAY SEPT 7 2024

The prizes are a custom-made money rosette that is created using the amount of cash on them listed under each prize, except for best junior handler in show that trophy will be a gift card from Chewy. All trophies must be picked up on the day of the event

BEST IN SHOW \$100 sponsored by Dave Showalter Sharcon Great Danes

OWNER HANDLER BEST IN SHOW \$75 sponsored by Sherry Larsen Unleashed Pet Resort In loving memory of Mercedes.

RESERVE BEST IN SHOW \$50 sponsored by Bone Appetit 174 W Telegraph St Ste 1, Washington, UT 84780 and 3540 Pioneer Pkwy, Santa Clara, UT 84765

RESERVE BEST IN SHOW OWNER HANDLER \$50 sponsored by Kim Thomas Concord Frenchies

SPORTING GROUP sponsored by Lorene Chidester of CHIC English Springer Spaniels

OWNER HANDLER SPORTING GROUP \$40 sponsored by Lorene Chidester of CHIC English Springer Spaniels

HOUND GROUP \$ 40 sponsored by Kristi Martin Ruffwyr Dachshunds in loving memory of Prissy - GrChB Ruffwyr's Orange Blossom Special SW

OWNER HANDLER HOUND GROUP \$40 Sponsored by: Leisa & Lauro Jaime, Slo-Poke Bassets in loving memory of Libby Officially known as DGCH GFC GCH DC Lloyal's Liberty Belle of Slo-Poke SHH, CGC TKN

WORKING GROUP \$40 sponsored by Misty Hamilton , MMK9s and Offleash K9 Training

OWNER HANDLER WORKING GROUP \$40 sponsored by Misty Hamilton , MMK9s and Offleash K9 Training

TERRIERS GROUP \$40 sponsored by Dr Heather Johnson Cedar Veterinary Clinic

OWNER HANDLER TERRIER GROUP \$40 In loving memory of Precious and Mesha sponsored by Custom Concrete Concepts

TOY GROUP \$40 Sponsored by Connie Sims

OWNER HANDLER TOY GROUP \$40 In loving memory of Precious and Mesha sponsored by Custom Concrete Concepts

NON-SPORTING GROUP \$40 Sponsored by Laurie Mueller in loving remember of Jim Mueller

OWNER HANDLER NON SPORTING GROUP \$40 sponsored by Karen Green Desert Reef Standard Poodles

HERDING GROUP \$40 In loving memory of Precious and Mesha sponsored by Custom Concrete Concepts

OWNER HANDLER HERDING GROUP \$40 Sponsored by Risa Baumrind Canaan dog fancier

Best in Misc Class \$40 Sponsored by Kathryn Martel Sunnystone Peruvian Hairless Dogs

Best Junior Handler in Show sponsored by Faith Burnham Oquirrh Greyhounds, in memory of Patricia Gail Burnham, who proved that anything is possible when you and your dog work together as a team.

OBEDIENCE HIGH SCORE IN SHOW \$40 Sponsored by Nancy Bentley

OBEDIENCE HIGH COMBINE SCORE IN OPEN B AND UTILITY \$45 Sponsored by Crissy Crismon & Jane Brennan in memory of Okeenan Timber Top on Target JH CD RA NA NAJ DN CGC

RALLY HIGH COMBINE ADVANCE B & EXCELLENT B \$45 sponsored by Polly Pierce in memory of the great Willow

RALLY TRIPLE SCORE IN ADVANCE B, EXCELLENT B AND MASTER CLASSES \$50 sponsored by Crissy Crismon & Jane Brennan in memory of Okeenan Timber Top on Target JH CD RA NA NAJ DN CG

SUNDAY SEPT 8 2024

The prizes are a custom-made money rosette that is created using the amount of cash on them listed under each prize, except for best junior handler in show that trophy will be a gift card from Chewy. All trophies must be picked up on the day of the event

BEST IN SHOW \$100 sponsored by Dave Showalter Sharcon Great Danes

OWNER HANDLER BEST IN SHOW \$75 sponsored by RANDY G. DELCORE, M.D Cedar Orthopedic

RESERVE BEST IN SHOW \$50 sponsored by Bone Appetit 174 W Telegraph St Ste 1, Washington, UT 84780 and 3540 Pioneer Pkwy, Santa Clara, UT 8476

RESERVE BEST IN SHOW OWNER HANDLER \$50 sponsored by Head to Tail Animal Chiropractic 724 W 500 S #100, West Bountiful, UT <http://www.utahanimalchiropractor.com/> makes trips every 6 weeks to southern Utah

SPORTING GROUP sponsored by Lorene Chidester of CHIC English Springer Spaniels

OWNER HANDLER SPORTING GROUP \$40 sponsored by Gail's Workman's Dog Obedience Training Made Easy

HOUND GROUP \$ 40 sponsored by Kristi Martin In memory of Wally GRB Ruffwyr's Wabash Cannonball SW 11/13/2007-5/26/2024

OWNER HANDLER HOUND GROUP \$40 sponsor by Grand River Dachshunds - Denise & Dana Gehring

WORKING GROUP \$40 sponsored by Krist Martin In loving memory of my brother Eric Palmer

OWNER HANDLER WORKING GROUP \$40 sponsored by Leona Fischer, Forestwood Great Pyrenees

TERRIERS GROUP \$40 sponsored by Rebecca White of WhiteOaks Cairn Terriers

OWNER HANDLER TERRIER GROUP \$40 Sponsored by In loving memory of Precious and Mesha sponsored by Custom Concrete Concepts

TOY GROUP \$40 Sponsored by Connie Sims

OWNER HANDLER TOY GROUP \$40 Sponsored by In loving memory of Precious and Mesha sponsored by Custom Concrete Concepts

NON-SPORTING GROUP \$40 Sponsored by Laurie Mueller in loving remember of Jim Mueller

OWNER HANDLER NON SPORTING GROUP \$40 sponsored by Karen Green Desert Reef Standard Poodles

HERDING GROUP \$40 Sponsored by Risa Baumrind Canaan dog fancier

OWNER HANDLER HERDING GROUP \$40 Sponsored by Risa Baumrind Canaan dog fancier

Best in Misc Class \$40 Sponsored by Kathryn Martel Sunnystone Peruvian Hairless Dogs

Best Junior Handler in Show sponsored by Kristi Martin In memory of Wally my drama queen boy know officially as GrChB Ruffwyr's Wabash Cannonball SW 11/13/2007-5/26/2024

OBEDIENCE HIGH SCORE IN SHOW \$40 Sponsored by Nancy Bentley

OBEDIENCE HIGH COMBINE SCORE IN OPEN B AND UTILITY \$45 Sponsored by Crissy Crismon in memory of Okeenas Utah Retirement Fun JH RA NJA JA CGC

RALLY HIGH COMBINE ADVANCE B & EXCELLENT B \$45 sponsored by Polly Pierce in memory of the great Willow

RALLY TRIPLE SCORE IN ADVANCE B, EXCELLENT B AND MASTER CLASSES \$50 sponsored by Crissy Crismon & Jane Brennan in memory of Okeenas Utah Retirement Fun JH RA NJA JA CGC

AKC National Owner-Handled Series
Offered Friday # 2 Show, Saturday, Sunday
NOHS is not offered Friday # 1 Show

The AKC National Owner-Handled Series is a non-titling competition for dogs that are exhibited by their owners that are not professional handlers.

Exhibitors must declare their dog is Owner-Handled eligible at the time of entry on the entry form. Dogs entered in the Amateur-Owner-Handler class will automatically be marked as eligible to compete in the NOHS. Eligible dogs will be identified by an asterisk in the judge's book, steward's book & the catalog. **Dogs must be handled throughout the breed level competition for the regular show by an eligible owner. Professional handlers*, household members and current assistants** to professional handlers may not exhibit the dog in any NOHS competition during the entire show.**

Owner-Handled Best of Breed will be selected from the dogs that are eligible to compete in the Best of Breed competition including Winners Dog, Winners Bitch and winners of the non-regular classes.

- If the Best of Breed/Variety winner is Owner-Handled competition eligible, it will automatically be Owner-Handled Best of Breed/Variety and be eligible to compete in both the regular as well as the Owner-Handled group.
- If the Best of Breed/Variety winner is not eligible for Owner-Handled competition and the Best of Opposite Sex to Best of Breed/Variety is eligible, the Best of Opposite Sex to Best of Breed/Variety will compete against the eligible exhibits of the other sex to determine Owner-Handled Best of Breed/Variety.
- If neither the Best of Breed nor the Best of Opposite Sex to Best of Breed/Variety are Owner-Handled competition eligible and Select Dog & Select Bitch are both eligible, the judge is to choose Best Owner-Handled exhibit from the Selects and eligible Winners Dog or Winners Bitch.
- If one of the Selects is eligible, excuse all Champions and non-regular class winners of the same sex and then choose Best Owner-Handled exhibit from the remaining dogs of the opposite sex including the eligible Winners.
- If Best of Breed, Best of Opposite Sex to Best of Breed, Select Dog & Select Bitch are not eligible, the judge may choose any eligible dog remaining in the ring including Winners Dog or Winners Bitch as Owner-Handled Best of Breed/Variety.
- If the Best of Winners is eligible, the other Winner is ineligible since it was defeated.
- No class dogs other than the Winners Dog & Winners Bitch are eligible to return to the ring.

The breed will not be represented in the Owner-Handled Group if there is no eligible dog competing in the Best of Breed or in Best of Winners competition.

**Professional handlers are defined as any person who belongs or has belonged to a professional handlers' organization, distributed rate cards, or otherwise advertised or represented themselves as handling dogs for pay within the last five years*

***A current assistant is defined as anyone employed by a professional handler on a full-time basis or assisting a professional handler at the show or any time during the cluster/weekend. Current assistants that are eligible to compete in Junior Showmanship (meet age & amateur status requirements) may participate in NOHS. AKC Revised 5/11/18*

	Friday # 1	Friday # 2	Saturday	Sunday
Sporting	NOHS	Ms. Kerr	Mr. Cole	Ms. Derrick
Hounds	IS	Ms. Derrick	Mrs.Klingel-Brown	Mr.Wade
Working	NOT	Ms. Derrick	Mr. Cline	Mrs. Trotter
Terriers	OFFERED	Mr. Cline	Mrs.Klingel-Brown	Ms.Graham
Toys	Friday	Mrs. Klingel-Brown	Ms. Derrick	Mr. Cline
NonSporting	# 1	Mr. Wade	Mr. Cole	Ms. Derrick
Herding	SHOW	Mrs. Trotter	Ms. Kerr	Mr. Cole
BISOH		Ms.Graham	Mr. Wade	Ms. Kerr
]	

ROUTES TO THE SHOW

FROM 1-15: EXIT 16 Hurricane SR 9 head South

Travel 2.5 miles southeast on State Route 9.

Then turn right at 5300 West. This is the second signal light. (if you turn left you will end up at Quail Creek Reservoir).

Then go about .4 mile

Follow 5300W pass the DMV.

Keep going as it merges onto 5500W.

Then to Washington County Legacy Park and Fairgrounds.

Parking lot will be on your left side Go past the buildings

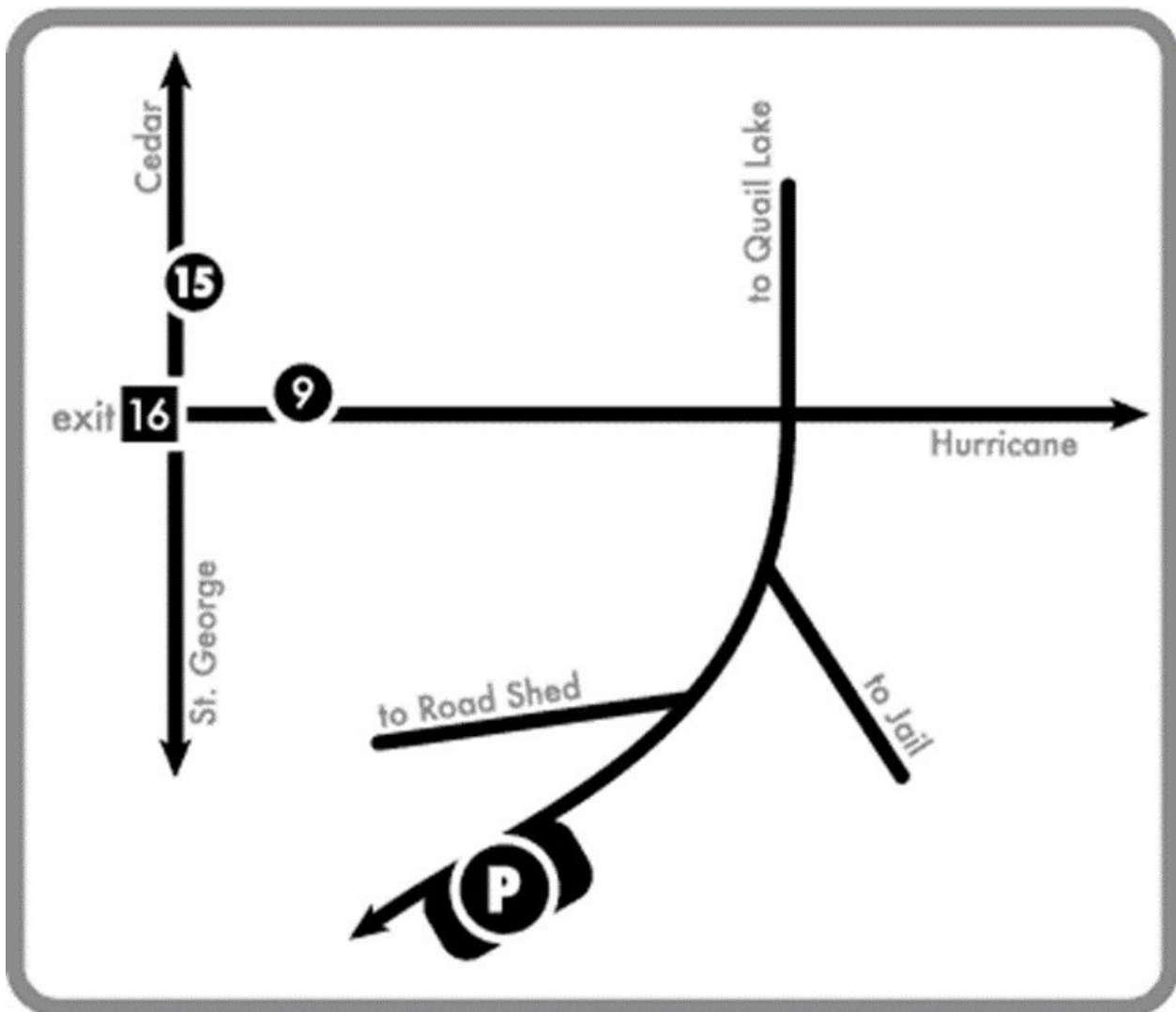



Fetch Trial will be located in the Outdoor Covered Arena

Each Entry fee \$32

Event No: 2024722211 - Friday September 6, 2024 – Shirley Alexander

Event No: 2024722212 - Saturday September 7, 2024 – Gail Workman

Fetch Title Structure Explained

AKC Fetch is a fun AKC Family Dog program in which dogs can earn four levels of AKC titles by demonstrating retrieving skills. Below is a breakdown of each title offered and a quick overview of what a dog must do to earn a title at each of the four test levels. Be sure to check out the [fetch test level videos](#) as well. There is also a quick test level [summary chart](#).

A dog must pass each test level twice in order to be able to apply for a title. Below are the four test level titles offered.

[Novice](#) – the dog earns the FTN (Fetch Novice)

[Intermediate](#) – the dog earns the FTI (Fetch Intermediate)

[Advanced](#) – the dog earns the FTA (Fetch Advanced)

[Retriever](#) – the dog earns the FTR (Fetch Retriever)

AKC Fetch will be held both Friday and Saturday in the Outdoor Covered Arena after Rally and Obedience is finished for the day.

OFFICIAL AMERICAN KENNEL CLUB ENTRY FORM



- Friday, Sept 6, 2024**
 Saturday, Sept 7, 2024

Red Canyons KC, Washington County Regional Legacy Park Farigrounds
5500 West 700 South, Hurricane, UT 84737

MAIL ENTRIES WITH FEES TO: JACK BRADSHAW, Supt., 320 Maple Avenue, Torrance, CA 90503
MAKE CHECKS payable to JACK BRADSHAW. FAX (323) 727-2949 website: www.jbradshaw.com
ENTRIES must be received by the Superintendent not later than **NOON, Wed, August 21, 2024 PT**
Each Entry at Fetch **\$32**

Breed: _____ **Sex: (Circle One)** **)Male** **Female**

Fetch Class: (Circle One) **Novice** **Intermediate** **Advanced** **Retriever**

Name of Dog: _____

AKC, PAL, ILP number _____

Owner _____

Address _____

I CERTIFY that I am the actual owner of the dog, or that I am the duly authorized agent of the actual owner whose name I have entered above. In consideration of the acceptance of this entry, I (we) agree to abide by the rules and regulations of the American Kennel Club in effect at the time of this event, and by any additional rules and regulations appearing in the premium list for this event, and further agree to be bound by the "Agreement" printed on the reverse side of this entry form. I (we) certify and represent that the dog entered is not a hazard to persons or other dogs. This entry is submitted for acceptance on the foregoing representation and Agreement. I (we) agree to conduct myself (ourselves) in accordance with all such Rules and Regulations (including all provisions applying to discipline) and to abide by any decisions made in accord with them.

Signature of owner or his agent
duly authorized to make this entry: _____

Daytime Telephone _____ Email _____

AKC Rules, Regulations, Policies and Guidelines are available on the American Kennel Club Web site, www.akc.org

AGREEMENT

I (we) agree that the club holding this event has the right to refuse this entry for cause which the club shall deem sufficient. In consideration of the acceptance of this entry and of the holding of this event and of the opportunity to have the dog judged and to win prizes, ribbons, or trophies, I (we) agree to hold the AKC, the event-giving club, their members, directors, governors, officers, agents, superintendents or event secretary and the owner and/or lessor of the premises and any provider of services that are necessary to hold this event and any employees or volunteers of the aforementioned parties, and any AKC approved judge, judging at this event, harmless from any claim for loss or injury which may be alleged to have been caused directly or indirectly to any person or thing by the act of this dog while in or about the event premises or grounds or near any entrance thereto, and I (we) personally assume all responsibility and liability for any such claim; and I (we) further agree to hold the aforementioned parties harmless from any claim for loss, injury or damage to this dog.

Additionally, I (we) hereby assume the sole responsibility for and agree to indemnify, defend and save the aforementioned parties harmless from any and all loss and expense (including legal fees) by reason of the liability imposed by law upon any of the aforementioned parties for damage because of bodily injuries, including death at any time resulting therefrom, sustained by any person or persons, including myself (ourselves), or on account of damage to property, arising out of or in consequence of my (our) participation in this event, however such, injuries, death or property damage may be caused, and whether or not the same may have been caused or may be alleged to have been caused by the negligence of the aforementioned parties or any of their employees, agents, or any other persons.

I (WE) AGREE THAT ANY CAUSE OF ACTION, CONTROVERSY OR CLAIM ARISING OUT OF OR RELATED TO THE ENTRY, EXHIBITION OR ATTENDANCE AT THE EVENT BETWEEN THE AKC AND THE EVENT-GIVING CLUB (UNLESS OTHERWISE STATED IN ITS PREMIUM LIST) AND MYSELF (OURSELVES) OR AS TO THE CONSTRUCTION, INTERPRETATION AND EFFECT OF THIS AGREEMENT SHALL BE SETTLED BY ARBITRATION PURSUANT TO THE APPLICABLE RULES OF THE AMERICAN ARBITRATION ASSOCIATION. HOWEVER, PRIOR TO ARBITRATION ALL APPLICABLE AKC BYLAWS, RULES, REGULATIONS AND PROCEDURES MUST FIRST BE FOLLOWED AS SET FORTH IN THE AKC CHARTER AND BYLAWS, RULES, REGULATIONS, PUBLISHED POLICIES AND GUIDELINES. 1/1/19



Please visit

<https://www.instagram.com/jackbradshawdogshows/>

for new information, updates, weather conditions, exhibitor information, etc."



Please like our page at

<https://www.facebook.com/JackBradshawDogShows>

for new information, updates, weather conditions, exhibitor information, etc."

SHOW VETERINARIAN

Southwest Animal Emergency Services (ON CALL) 1067 E Tabernacle, St George UT 84770 • (435) 673-3191

DIRECTIONS TO SOUTHWEST ANIMAL EMERGENCY SERVICES: Go back to I-15, head south toward St George. Follow I-15 S to Exit 8 to St George Blvd. Turn right on St George Blvd & then left on 1000 East. Take the next left at Tabernacle & go about a block.

Lava Rock Veterinary Hospital Pet's Urgent Care Hours Tuesday – Friday 10am-10pm
Saturday 10am-6pm Closed Sunday & Monday
Limited Holiday Hours Walk-Ins Only Friday and Saturday 200N 1000E St. George, UT, 84770
For emergencies or scheduling call us at 435-288-0288
For general questions you can text us at 435-359-4494

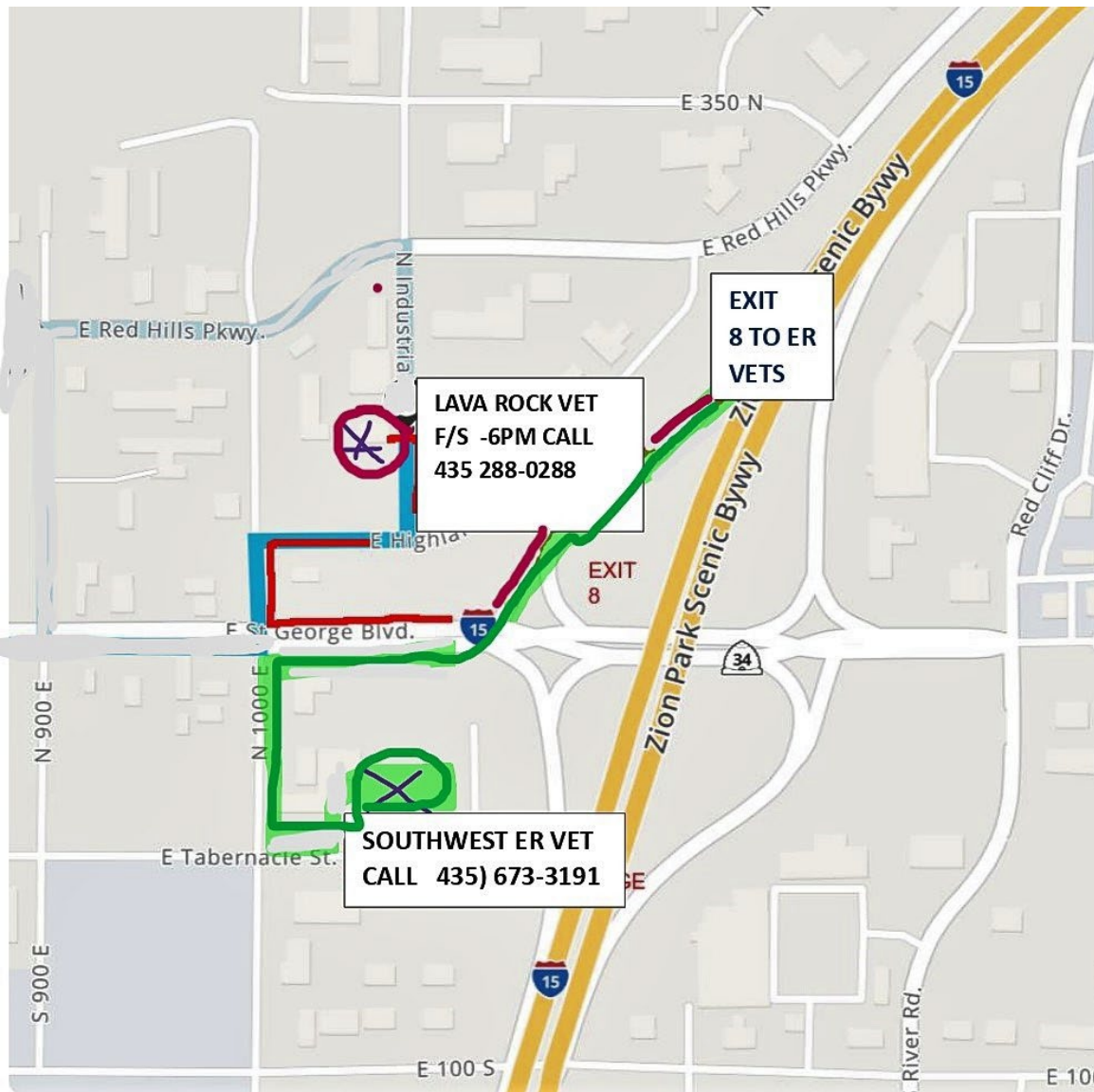

Exhibitors should follow their veterinarians' recommendation to assure their dogs are free of internal and external parasites, any communicable diseases, and have appropriate vaccinations.

Welcome All Dog Fanciers to Southern Utah

Planning to come to the Red Canyons Kennel Club, AKC Class A Show? In addition to our all-breed conformation and Rally/ Obedience Shows, there is so much to see and do here in Southern Utah.

The area is rated one of the most scenic parts of the USA. For the outdoor enthusiasts, there are plenty of hiking, biking, off-roading, and photography opportunities. In less than a couple of hours you can get to the Big Five National Parks, north rim of the Grand Canyon and lots of State Parks, Monuments and BLM lands. You can travel from high desert to awe-



inspiring rock formations, to alpine forests in a single day.

For the amateur archeologist, geologist, paleologist, there are petroglyphs and dinosaur sites throughout the region. Washington and Iron counties host numerous city parks and trails.



For the more “inside” adventurer, Southern Utah has is host to:

Tuacahn Center for the Arts (www.tuacahn.org)
 One of the largest Shakespeare Festival in the Country
 (www.bard.org)



UTAH SHAKESPEARE FESTIVAL

- Kanab Museum
- St George Opera House
 - o Southern Utah Museum of Art
- Sand Hollow Aquatic Center
- St George Dinosaur Discovery Site (www.utahdinosaurs.org)
- 18 golf courses in Washington County and 3 in Iron County
 (www.golflink.com/golf-courses/ut/washington/)
- And many, many more places to see and enjoy



See for yourself why Southern Utah is one of the fastest growing parts of the Country. Need to plan your stay? Check out our Preferred Hotel/Motels/RV Park list in the Premium. 30amp and 50amp RV parking will be offered at the County Fairgrounds, through the Club. For reservations, go to our website (www.redcanyonskc.org).





Red Canyons Kennel Club Class A Show

\$135

Call (435) 634-7768 to make your reservation



**Complimentary Breakfast
Special Gift Bag
Pet Photo Opp Spots
4 Pet Maximum**

by HILTON™

1251 S Sunland Dr.
St. George, UT 84790



Address

205 North 1000 East, St. George, UT, 84770

Phone

(435) 628-7979

Website (For Info & reservations)

<https://www.motel6.com/en/home/proper>

[ty/st-george.html](https://www.motel6.com/en/home/proper/ty/st-george.html)

We'll leave the light on for you

Motel 6 Saint George, Ut

#4673 | ★★★★★ 1710 reviews

Motel 6 Saint George, UT is a proud supporter of the Red Canyons Kennel Club AKC Class A Show this year. In addition to the amenities listed below, Hotel Management is willing to relax the number of dogs allowed per room. They understand the unique needs for dog show exhibitors.

Hotel amenities

Pets allowed

Disabled access

Business center

Nonsmoking rooms

Balcony

Free parking

Swimming pool

Restaurant on site

Snacks soda coffee candy Deli

Television in room

Free WiFi

Family friendly

Air conditioning

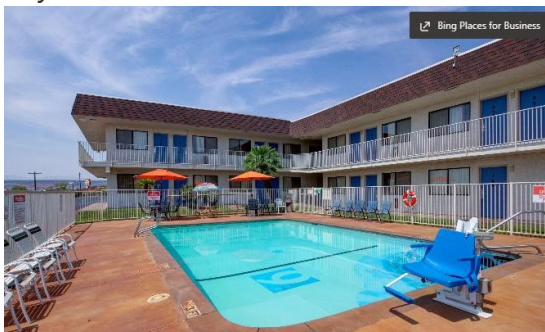

Red Canyons Kennel Club Preferred Hotels, Motels, and RV Parks

First - Thank you to all prior years' Exhibitors! A common comment made by Hotel/Motel/RV Park Management is what a pleasure it is hosting our Red Canyons Kennel Club Show participants and how much they enjoy having all the beautiful dogs walking around their property. The following is a list of Preferred Providers which allow dogs. Some have even relaxed parts of their pet policies and/or offer discounted room rates – Let them know that you are coming to the RCKC Dog Show and confirm all the details and policies below when making reservations.

Tru by Hilton (435)634-7768 / 1251 Sunland Dr, St George UT (13 miles to Fairgrounds) Tru by Hilton St. George UT St. George | Bookonline.com Tru is going all out this year to make your dog show stay a memorable one. **They are offering special room rates and have relaxed their policy to allow up to 4 dogs per room. Check out their full-page ad, included in the Premium, for more details and special benefits for our Exhibitors.**

Motel 6 St George Utah (435) 628-7979 / 205 North 1000 East, St. George, UT, 84770 (14 miles) / <https://www.motel6.com/en/home/property/st-george.html>
Motel 6 is known for their budget friendly rates and Motel 6 St George is no exception. There is no additional charge for 2 dogs and they understand the special needs for dog show people so they are relaxing their policy to allow additional dogs per room. Check out their amenities in the full-page ad included in the Premium. Motel 6 St George wants to welcome all our Exhibitors to town and is also a proud Group Rosette Sponsor

Holiday Inn Express (435) 986-1313 / 2450 N Town Center Dr, Washington UT 84780 (13 miles) / www.reservationdesk.com/hotel/611fe1e/holiday-inn-express-st-george-north-zion-washington-ut/ Holiday Inn Express has been a preferred hotel for a few years now. They are offering a block of rooms at a discounted rate. Pet policy allows up to 2 dogs per room at \$25 per dog/per day. There are several pet relief centers around the property for your convenience.

My Place Hurricane Hotel (435)635-8888 / 1167 West 80 S , Hurricane UT 84737 (4 miles) www.myplacehotels.com/my-place-hotel-hurricane-ut My Place is allowing up to 3 dogs per room for an additional \$10 per room per night. Rooms include a “My Kitchen” feature with refrigerator, 2 burner cooktop and microwave. Check their website for more details.

Best Western Plus Zion West Hotel (435)635-.0277 or Toll Free (800)780-7234 / 44 W 500 N, LaVerkin UT / Pet Policy = Up to 2 pets for \$20 per day with \$100 week max. Large grassy area available for leashed pets

La Quinta (435)635-3111 (Current pet policy not confirmed) 101 E 500 N, LaVerkin UT 84745

RV Parking

Willow Wind RV (435)635-4154 80 S 1150 W Hurricane UT 84737 (6.5 Miles)
Small off-leash dog run available plus several pick up spaces and dog walking areas

KOA STG/Hurricane (435)850-6382 (Not Confirmed) 5800 N Old Hwy 91, Hurricane UT 84737

Zion West RV Park (Smaller rigs) 175 S Valley Rd Hurricane 84746
Southern Utah RV Park 435 669.2242 720 E merit Way, Washington UT 84780
Minimum 1 week reservation (7th day free) . Call for current amount of pet fee. Park provides grassy fenced in areas where dogs may be let off leash.

There are numerous other first-rate hotels in the area as Southern Utah is a major tourist destination area due to the multitude of recreational activities.

5500 WEST

NON-ELECTRIC

5500 WEST

GRAFTON BUILDING

RALLY & OBEEDIENCE RINGS

VENDORS
RING 8
RING 7
JUDGE HOSP
CLUB & RAFFLE

HARMONY BUILDING

DAY PARKING # 1

RV LOT
ELECTRIC 30 AMP
1 2 3 4 5

SUPERINTENDENT CLUB PHOTOS
INDOOR ARENA
RING 1 RING 4
RING 2 RING 5
RING 3 RING 6
BLEACHER SCRATCHING
CRATING BLEACHERS
R
1
HANDICAP PARKING

24 6
25 7
26 8
27 9
RV LOT 10
11
12
13
28 14
29 15
30 16
31 17
RV 18
24-31 19
DRY 20
21
22
23
RV 6023
30 AMP

3
GROOMING
R

DOG RELIEF
4

2
BLEACHERS
FETCH
COVERED ARENA
PERSONAL GROOMING

ELECTRIC 50 AMP SPACES 32-41

32 33 34 35 36 37 38 39 40 41

DAY PARKING #2

RV OVERNIGHT PARKING

Online Reservations will open on May 20, 2024

All reservations for overnight parking will be taken online at our club website link:

<https://www.redcanyonskc.org/product/rv-parking/>

RCKC Website link: <https://www.redcanyonskc.org/>

Please read the instructions and refer to the diagram before making your reservations as the parking layout numbering system has been revised.

Reservations close on NOON, Wed, August 21, 2024 PDT, at which time no refunds will be issued. You are welcome to sell or give away your space after reservations close, but you must let us know who will be using that space.

All reservations are first come first served.

Prices include from 3:00 pm Thursday - Sunday 9:00 pm .

No partial days accepted.

If you wish to stay Sunday evening, you must get approval through the Show Chair no later than Sunday at 10:00 am. All vehicles will be required to vacate the premises by 10:00 am Monday morning.

Conformation Rings: 1-6 in INDOOR ARENA, 7-8 in Harmony Building

Obedience / Rally Rings: 9-10 Grafton Building

POWER RV – 10 - 50 amp,
23 - 30 amp
12 – non-electric

20 x 48 spaces maximum.

Anything longer than 48 must unhook and park in the back of day- parking area, or purchase two power RV spaces.

Prices:

\$250 – 50 amp RV SPACES 32-41

\$180 – 30 amp RV SPACES 1-5 & 6-23

\$125 – non-electric, SPACES 24-31 & 42-45



Red Canyon Kennel Club OFA Health Clinics

. We Please to announce we have two wonderful Veterinarians to do our Health Clinic, Please take advantage of the services offered by the specialists that we arranged to do our OFA and Health Clinic at discounted rate.

- **Date Sat & Sun Sept 7 & 8 2024**
- **Time 9-5 pm both Saturday and Sunday**

Appointments must be scheduled at the show, or you are welcome to be a walk-in customer

Amy Knollinger, DVM, DACVO for Eye Cert Exams will be \$45.00

Julia Alpert, DVM Will be offering the following:

OFA Thyroid \$150

Cardiac by Auscultation \$25

OFA Patella \$25

OFA Dentition \$25

Rabies Vaccination \$25

Microchip (AKC ISO compatible) \$35

Brucellosis Testing \$55

Ultrasound for Pregnancy \$75

RCKC RESERVED GROOMING

Indoor grooming spaces are available for reservation online in the horse stall building. It is a cooled building with all spaces being approximately 10 x 10 feet. The cost is **\$95** per space for the entire weekend. See grooming building hours and online reservation link below. Each space will be approximately 10ft x 10ft and any variance in individual spaces must be accepted. **Power is shared** from overhead outlets and poles which are not exclusive to individual spaces. Please bring extension cords for access to the power. Club ladders will be available in the building should you need to access high overhead power. Some stalls will have club extension cords attached to the higher outlets available for use. Please do not remove these extension cords. If you have a stall with an outlet pole you **MUST** share it. Forced air dryers and stand dryers are permitted for use inside your stall only. Generators will not be permitted in the grooming building. Bathing tub stations are provided courtesy of RCKC.

A list of reserved stalls assignments will be posted at the main door to the grooming building.

Reserved grooming building hours will be as follows:

Thursday 3:00 PM - 10:00 PM

Friday & Saturday 6:00 AM - 10:00 PM

Sunday 6:00 AM - 6:00 PM

Dogs are permitted to be left overnight in the grooming building at their own risk and with the following guidelines.

RCKC will not be held liable and/or responsible for dogs left unattended in the grooming building. RCKC will have building security overnight, but this is for building safety, and not to interact with the dogs in the stalls.

No dogs should be left unattended on grooming tables at any time. It is the sole responsibility of the exhibitor to attend to their dog's safety. Failure to follow the rules and regulations or the instructions of any show committee member may result in the forfeiture of your grooming space. **Exhibitors are responsible to keep their reserved space clean. Do NOT leave trash in your stall or in the aisles.** Please respect the adjoining spaces of the others around you. RCKC will not be responsible for lost, damaged, or stolen items in the grooming building. You are welcome to padlock your space during the show.

Vehicles will have 30 minutes to unload in the area marked for unloading, then you must move your vehicle to designated parking areas. Vehicles left in the unloading area more than 30 minutes may be towed or ticketed. Vehicles that are towed are at the owner's expense.

RESERVATIONS WILL BE TAKEN ONLINE THROUGH RED CANYON KENNEL CLUB'S SHOW PAGE WHERE YOU WILL NEED TO USE THE RESERVED GROOMING SYSTEM:

Grooming Link

<https://www.redcanyonskc.org/product/grooming-stations>

Grooming spaces are limited. We recommend that you reserve your space online to guarantee that you will have one. If you desire to be with another exhibitor, you must purchase your reservations together. No more than 4 spaces per reservation and no guarantee of more than 2 adjoining spaces. If there are any remaining grooming spaces available, they may be reserved on the day of the show on a first come-first served basis. Please read all reservation information before submitting your reservation.

OFFICIAL AMERICAN KENNEL CLUB ENTRY FORM

- RED CANYONS KENNEL CLUB, Friday, Sept 6, 2024 AM SHOW 1**
- RED CANYONS KENNEL CLUB, Friday, Sept 6, 2024 PM SHOW 2**
- RED CANYONS KENNEL CLUB, Saturday, Sept 7, 2024**
- RED CANYONS KENNEL CLUB, Sunday, Sept 8, 2024**

WASHINGTON COUNTY REGIONAL LEGACY PARK FAIRGROUNDS
5500 West 700 South (Indoor & Covered Arena), Hurricane, UT 84737

MAIL ENTRIES WITH FEES TO: JACK BRADSHAW, Supt., 320 Maple Avenue, Torrance, CA 90503
MAKE CHECKS payable to JACK BRADSHAW. FAX (323) 727-2949 website: www.jbradshaw.com

ENTRIES must be received by the Superintendent not later than **NOON, Wed, August 21, 2024 PT**

FIRST ENTRY of a dog at each show **\$36.00**, Each additional entry of the same dog **\$32.00**

ENTRY MUST BE SIGNED at the bottom by the owner or owner's duly authorized agent, otherwise entry cannot be accepted. I enclose \$_____ for entry fees.

BREED		VARIETY 1		SEX
DOG ² ₃ SHOW CLASS		CLASS ³ DIVISION <small>Weight, color, etc.</small>		
ADDITIONAL CLASSES	OBEDIENCE CLASS (Jump Height)	RALLY CLASS (Jump Height)	JR. SHOWMANSHIP CLASS	
NAME OF (See Back) JUNIOR HANDLER (if any)				JR. HANDLER NUMBER
FULL NAME OF DOG				
<input type="checkbox"/> AKC® NO. <input type="checkbox"/> PAL NO. <input type="checkbox"/> FOREIGN REG NO & COUNTRY		Enter number here	DATE OF BIRTH	
			PLACE OF BIRTH (list country) <small>Do not print the above in the catalog.</small>	
BREEDER				
SIRE				
DAM				

ACTUAL OWNER(S) _____
4 (Please Print)

OWNER'S ADDRESS _____

CITY _____ STATE _____ ZIP _____

NAME OF OWNER'S AGENT
(IF ANY) AT THE SHOW _____

I CERTIFY that I am the actual owner of the dog, or that I am the duly authorized agent of the actual owner whose name I have entered above. In consideration of the acceptance of this entry, I (we) agree to abide by the rules and regulations of the American Kennel Club in effect at the time of this event, and by any additional rules and regulations appearing in the premium list for this event, and further agree to be bound by the "Agreement" printed on the reverse side of this entry form. I (we) certify and represent that the dog entered is not a hazard to persons or other dogs. This entry is submitted for acceptance on the foregoing representation and Agreement. I (we) agree to conduct myself (ourselves) in accordance with all such Rules and Regulations (including all provisions applying to discipline) and to abide by any decisions made in accord with them.

Signature of owner or his agent duly
authorized to make this entry: _____

Daytime Telephone _____ Email _____

Emergency Contact _____ Phone _____

Owner/Handler Eligible? Yes No

AKC Rules, Regulations, Policies and Guidelines are available on the American Kennel Club Web site,
www.akc.org

AGREEMENT

I (we) agree that the club holding this event has the right to refuse this entry for cause which the club shall deem sufficient. In consideration of the acceptance of this entry and of the holding of this event and of the opportunity to have the dog judged and to win prizes, ribbons, or trophies, I (we) agree to hold the AKC, the event-giving club, their members, directors, governors, officers, agents, superintendents or event secretary and the owner and/or lessor of the premises and any provider of services that are necessary to hold this event and any employees or volunteers of the aforementioned parties, and any AKC approved judge, judging at this event, harmless from any claim for loss or injury which may be alleged to have been caused directly or indirectly to any person or thing by the act of this dog while in or about the event premises or grounds or near any entrance thereto, and I (we) personally assume all responsibility and liability for any such claim; and I (we) further agree to hold the aforementioned parties harmless from any claim for loss, injury or damage to this dog.

Additionally, I (we) hereby assume the sole responsibility for and agree to indemnify, defend and save the aforementioned parties harmless from any and all loss and expense (including legal fees) by reason of the liability imposed by law upon any of the aforementioned parties for damage because of bodily injuries, including death at any time resulting therefrom, sustained by any person or persons, including myself (ourselves), or on account of damage to property, arising out of or in consequence of my (our) participation in this event, however such, injuries, death or property damage may be caused, and whether or not the same may have been caused or may be alleged to have been caused by the negligence of the aforementioned parties or any of their employees, agents, or any other persons.

I (WE) AGREE THAT ANY CAUSE OF ACTION, CONTROVERSY OR CLAIM ARISING OUT OF OR RELATED TO THE ENTRY, EXHIBITION OR ATTENDANCE AT THE EVENT BETWEEN THE AKC AND THE EVENT-GIVING CLUB (UNLESS OTHERWISE STATED IN ITS PREMIUM LIST) AND MYSELF (OURSELVES) OR AS TO THE CONSTRUCTION, INTERPRETATION AND EFFECT OF THIS AGREEMENT SHALL BE SETTLED BY ARBITRATION PURSUANT TO THE APPLICABLE RULES OF THE AMERICAN ARBITRATION ASSOCIATION. HOWEVER, PRIOR TO ARBITRATION ALL APPLICABLE AKC BYLAWS, RULES, REGULATIONS AND PROCEDURES MUST FIRST BE FOLLOWED AS SET FORTH IN THE AKC CHARTER AND BYLAWS, RULES, REGULATIONS, PUBLISHED POLICIES AND GUIDELINES. 1/1/19



Please visit

<https://www.instagram.com/jackbradshawdogshows/>

for new information, updates, weather conditions, exhibitor information, etc."



Please like our page at

<https://www.facebook.com/JackBradshawDogShows>

for new information, updates, weather conditions, exhibitor information, etc."

ADDITIONAL RULES

1. Entries must reach the Superintendent, Jack Bradshaw by Noon, Wednesday August 21, 2024. Fees should accompany entries. This club and/or its superintendent assumes no responsibility for wrong or incomplete information given on the entry blank by the owner or agent of the owner. This club and its superintendents assume no responsibility for the owner or owner's agents entering a dog in a class in which the dog is not eligible to compete, or for entering the same dog twice.
2. Returned Checks do not constitute a valid entry fee. The Superintendent will add a collection fee to the amount of each returned check and declined credit card. Subsequent returned checks for the same exhibitors may result in their being put on a CASH ONLY basis. The returned check or declined credit card MUST BE MADE GOOD by cash or money order BEFORE the dog will be allowed in the ring.
3. Exhibitors' Identification tickets and judging programs will be mailed to the address given on the entry blank. If not received within a reasonable time prior to the show, notify the superintendent. Tickets returned by the Post Office marked 'undeliverable' will be held at the Superintendent's Office. PLEASE BRING YOUR IDENTIFICATION TICKETS TO THE SHOW.
4. During the hours of judging owners are to be on call, and have their dogs ready to bring into the judging ring promptly. In order that the judging will not be delayed. Dogs need only be present for their judging. Dogs not needed for further judging may be excused. It is the responsibility of the exhibitor to have his dog ready to be shown and at the entrance of the judging ring when the steward calls for the class. Owners of dogs or the handlers of the dogs alone are responsible for the presence of their dogs in the judging rings. This means it is not the responsibility of the ring steward, nor of any agent of the show-giving club to locate any dog, its owner or handler, when the dog's presence is needed in a judging ring. It should be understood by every exhibitor and handler that waiting for dogs to be brought into the ring is a courtesy extended to the owner or handler of the dog. There is no rule of this club nor of The American Kennel Club that requires a judge to wait for an owner or handler to bring his dog into the ring. Because of the Covid-19 pandemic, all exhibits no longer needed for judging and their owners/handlers are asked to leave the Showgrounds as soon as possible.
5. All Trophies and Prizes must be claimed at the Trophy Table. All trophies must be claimed the day of the show. None will be mailed.
6. Exhibitors are admonished to make themselves familiar with the agreement of the American Kennel Club, referred to on the reverse side of the entry blanks that accompany this premium list. Rule books are available online at akc.org
7. The club, its superintendents or their employees will not be responsible for the loss of or damage to any dog exhibited, whether the result of accident or other causes and in addition assumes no responsibility for any loss, damage, injury or death sustained by an exhibitor or handler. It is distinctly understood that every dog at this show is in the care and custody and control of his owner or handler during the entire time the dog is on the show premises.
8. No grooming tables, pens or exhibitors' setups will be allowed in the aisles and all grooming must be done away from the judging ring in areas specified by the club.
9. Entry fees shall NOT be refunded in the event that a dog is absent, disqualified, sick, lame, excused by veterinarian or judge, barred from competition by action of the Bench Show Committee, or because the dog is ineligible to compete due to being entered incorrectly. There is no refund of entry fee for duplicate entry. There will be a \$4.00 fee charged for cancellation of entry prior to closing of entries.
10. There is no provision offered for unentered dogs at this show.
11. Declination of Entries. The Red Canyons Kennel Club may decline any entries for cause and may refuse to receive or may remove any dog on account of disease, viciousness or other causes, and no one shall have any claim or recourse against the Kennel Club or any official thereof.
12. If, because of riots, civil disturbances or other acts beyond the control of the management, it is impossible to open or complete the show, no refund of entry will be made.
13. Do not leave any dogs in closed vehicles.
14. Dogs which according to their owners' records have completed the requirements for a championship after the closing of entries for the show but whose championships are unconfirmed, may be transferred from one of the regular classes to the Best of Breed or Variety Competition, provided this transfer is made by the Superintendent at least one-half hour prior to the start of the earliest Conformation judging at the Show.
15. Junior Handlers who win a third Novice Class after the closing of entries for a show may transfer their entry from the Novice Class to the Open Class provided that this transfer is made by the Superintendent at least one half-hour prior to the scheduled start of the earliest conformation judging or one half-hour prior to the scheduled start of Junior Showmanship judging at the Show, whichever is earlier.
16. All rights to TELEVISION, VIDEOTAPE, ADVERTISE, PHOTOGRAPH, PROMOTE or otherwise exploit this event are vested in the CLUB, or in persons to whom assignments of such rights have been made in writing by the Club. All persons and animals on the Showgrounds at any time while the show is in progress, do by attending this show or participating therein, grant to the Club the right to photograph, televise, video tape, audiotape or otherwise use their likeness and voice in any manner without further release or consent.
17. The Kennel Club is not responsible for the actions or products of the commercial vendors at this show.
18. Dogs which according to their owners' records have earned an obedience or rally title after the closing of entries for the show may be moved up to the next class, provided this transfer is made in writing and presented to the superintendent at least 30 minutes prior to the start of each trial.
19. No practicing is allowed in the rings at any time.
20. Parents and/or guardians are responsible for the actions of their children.
21. By attending this event, you acknowledge that an inherent risk of exposure to COVID-19 exists in any public place where people are present and agree not to hold the superintendent liable for any illness, injury.
22. By attending this event, you voluntarily assume all risks related to exposure to COVID-19 and agree not to hold Jack Bradshaw Dog Shows, its owners, employees, or volunteers liable for any illness, injury..

